



*Elizabethan
Classics*

Assembly Instructions for ES01-03

CAUTION: DO NOT OVER TIGHTEN NUTS AND SCREWS- THIS CAN LEAD TO STRIPPING OR CRACKING AND WILL VOID YOUR WARRANTY.

NOTE: TO BE INSTALLED ONLY BY QUALIFIED, LICENSED PLUMBER

NOTE: USE TEFLON TAPE ON ALL THREADED CONNECTIONS

1. Shut off the main water supply valves before installation.
2. Thread the Brass Nipple into wall stub, the nipple should extend 3/8" to 1/2" from the front of the finished wall.
3. Remove the Eccentric Shanks from faucet and keep escutcheons on shanks.
4. Thread Eccentric Shanks onto each cold and hot Brass Nipple. Ensure each escutcheon is snug against the finished wall.
5. Align and level Eccentric Shanks with a 10mm Allen wrench. Ensure the center distance of Coupling Nuts is 3-1/2".
6. Insert one Rubber Washer into each cold and hot Coupling Nut.
7. Insert the faucet into each cold and hot Coupling Nut. Partially thread the Coupling Nuts onto faucet until tight.
8. Thread the Riser Connector onto faucet.
9. Thread the Riser onto 90 degree elbow. Slide the Brace Connector onto Riser.
10. Slide the Riser Nut onto Riser and install the Cone Washer at end of Riser. Insert the Riser into the Riser Connector. Align showerhead toward the front. Tighten the Riser Nut onto Riser Connector
11. Measure the distance from Brace Connector to the wall. Cut the unthreaded end of Brace. Move the Brace Connector to the location which is approximate 11-1/2" below the 90 degree elbow to hide the connecting seam on Riser. Fix the Brace Connector by Set Screw. Insert the unthreaded end into Brace Connector and install the Brace to finished wall by Anchor Bolts.

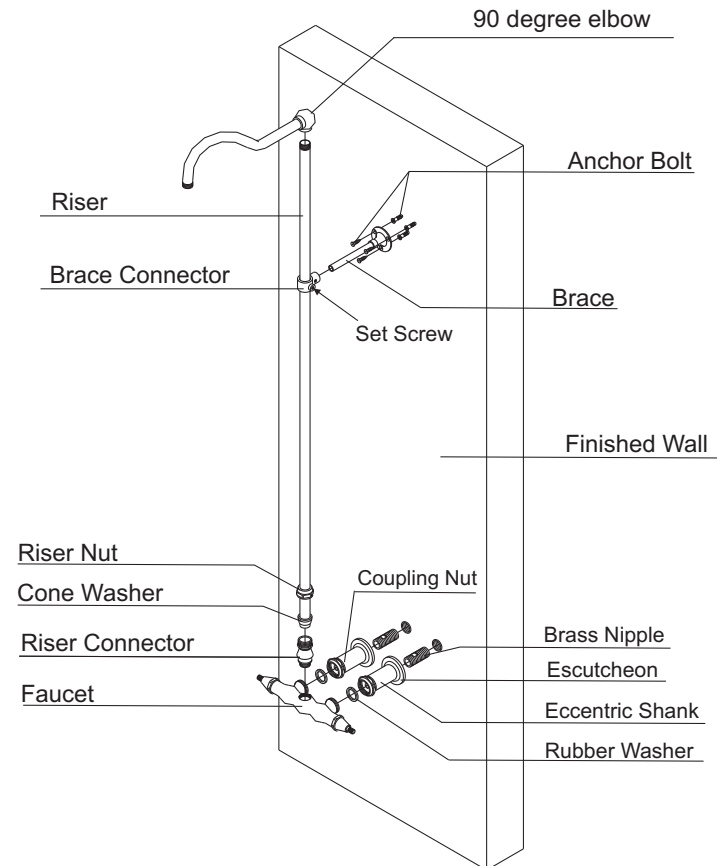

Assembly Instructions for Handles

Lever Handles:

1. Be sure that the broach screws are tightened before installing the lever handles.
2. Install the lever handles on the broaches and tighten the set screws using the allen wrench provided.

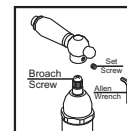

Cross Handles:

1. Remove the screws from the top of the broaches.
2. Remove the insert caps from the cross handles.
3. Put the cross handles on the broaches and then tighten the screws. Insert the caps on the cross handles.

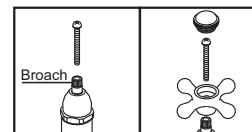

Rev.B