

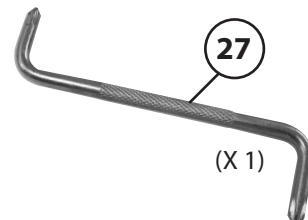

# Nordic UTV Plow (With Hitch Receiver)

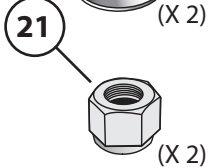

..... 2	DANSK.....16
ENGLISH..... 9	NORSK.....17
FRANCAIS.....10	SVENSKA.....18
ITALINO..... 11	POLSKI.....19
NEDERLANDS..... 12	CESTINA.....20
ESPAÑOL.....13	MAGYAR.....21
PORTUGUES.....14	XXXXXX.....22
XXXXXX.....15	XXXXXXXX.....23

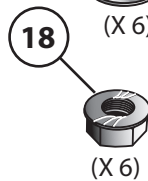
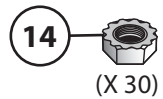
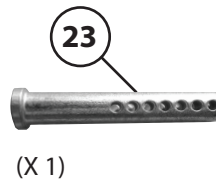
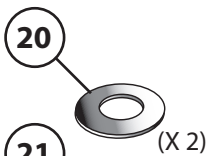
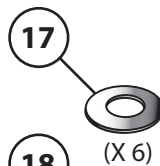
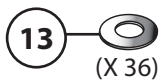
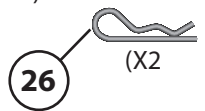
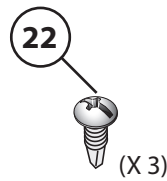
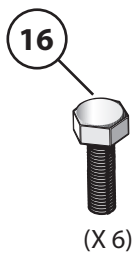
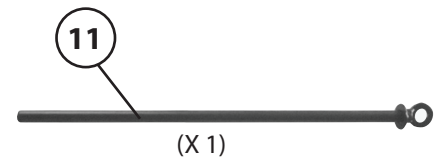
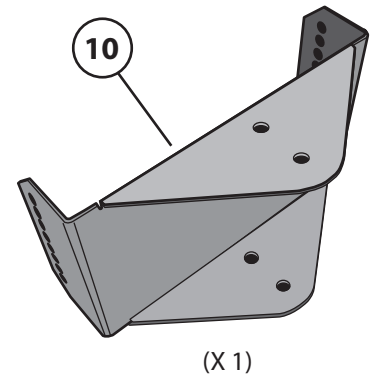
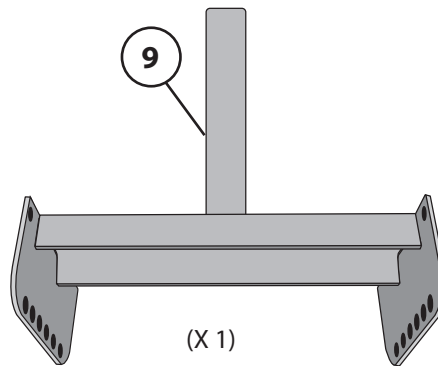
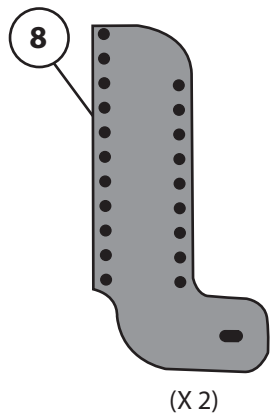
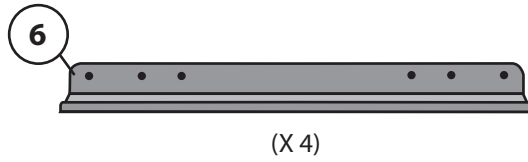
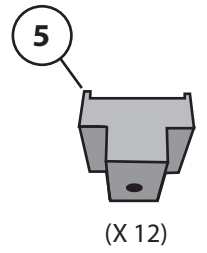
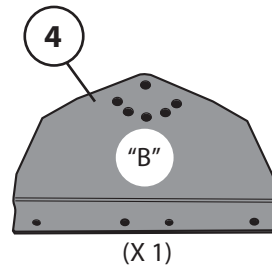
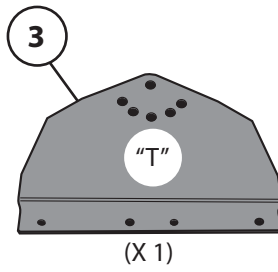
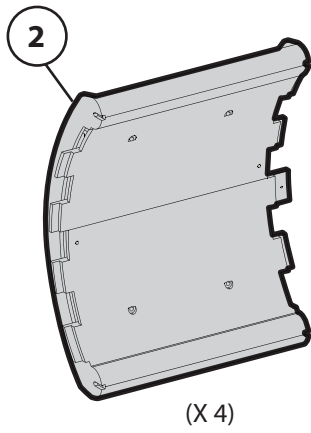
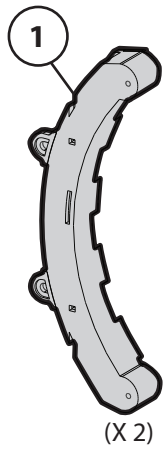

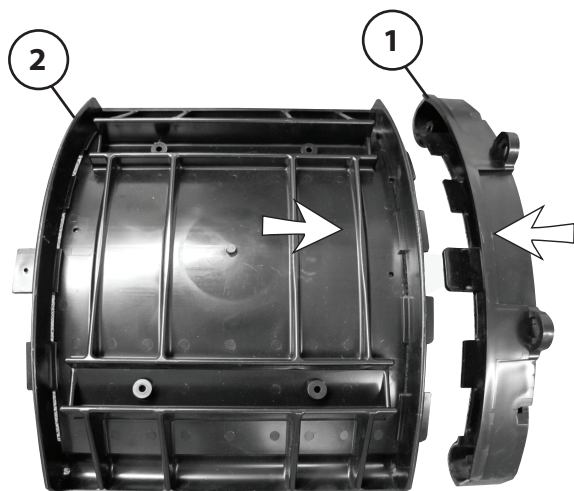
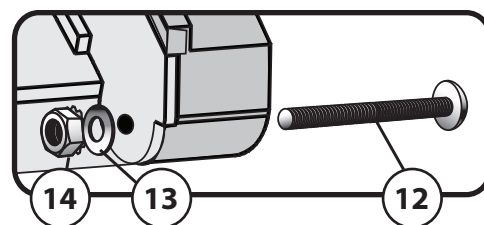
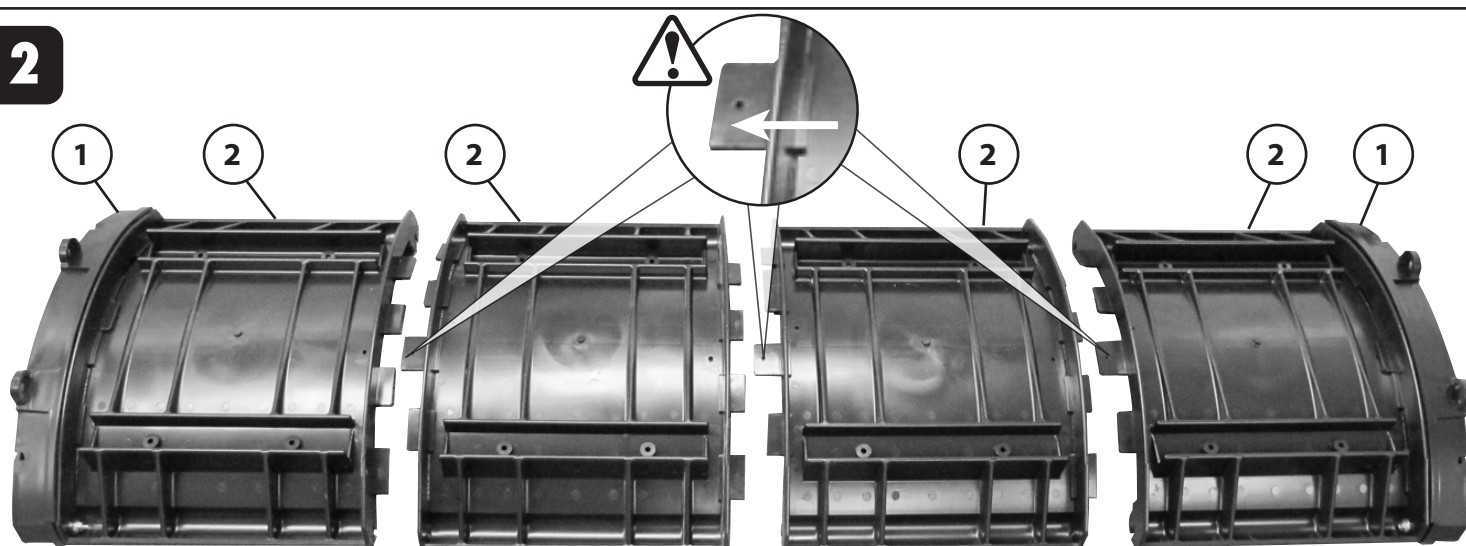
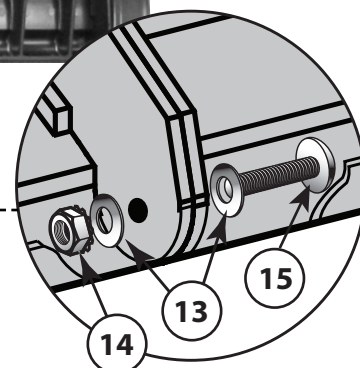
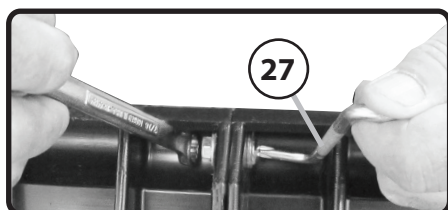
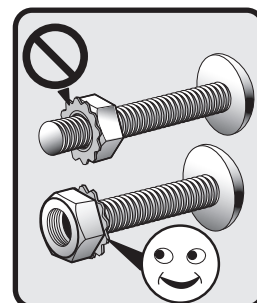
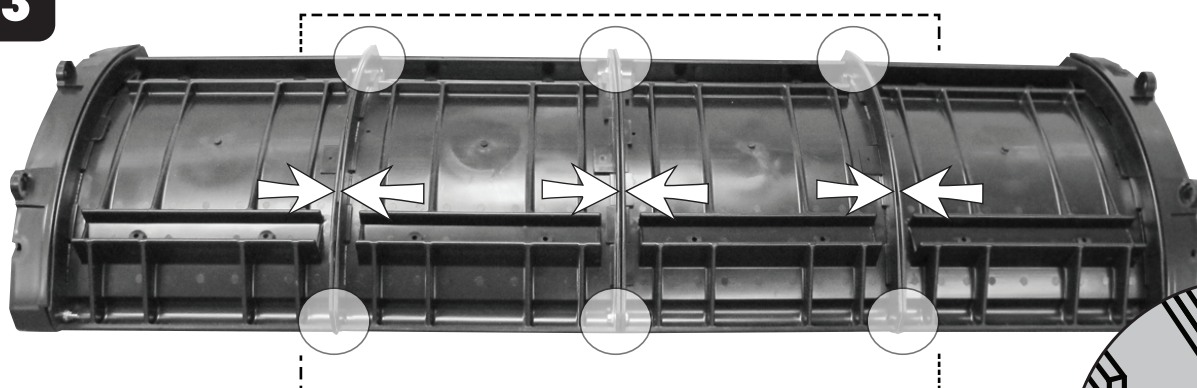
**1****X2****2****3****3**



4

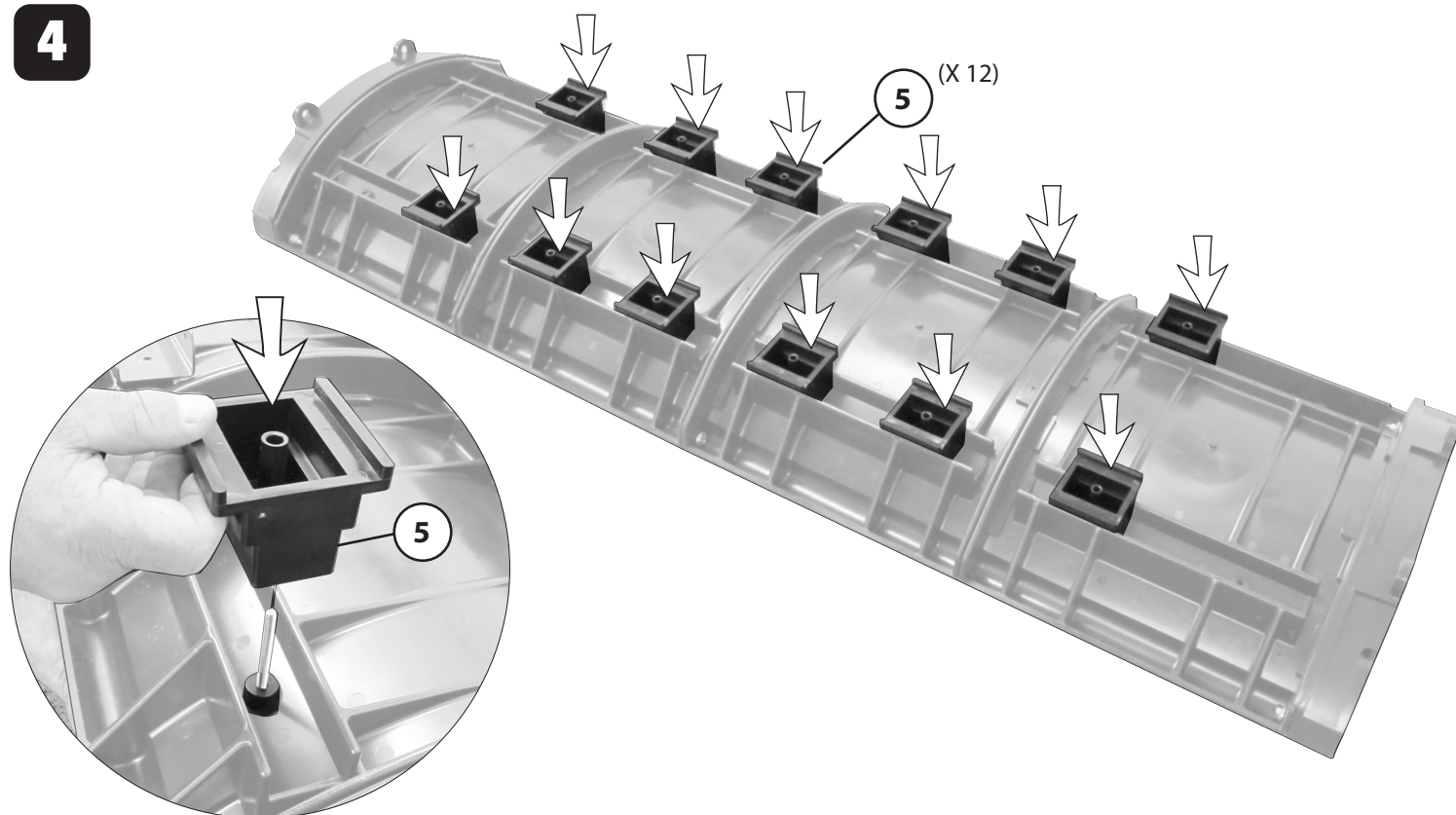

5

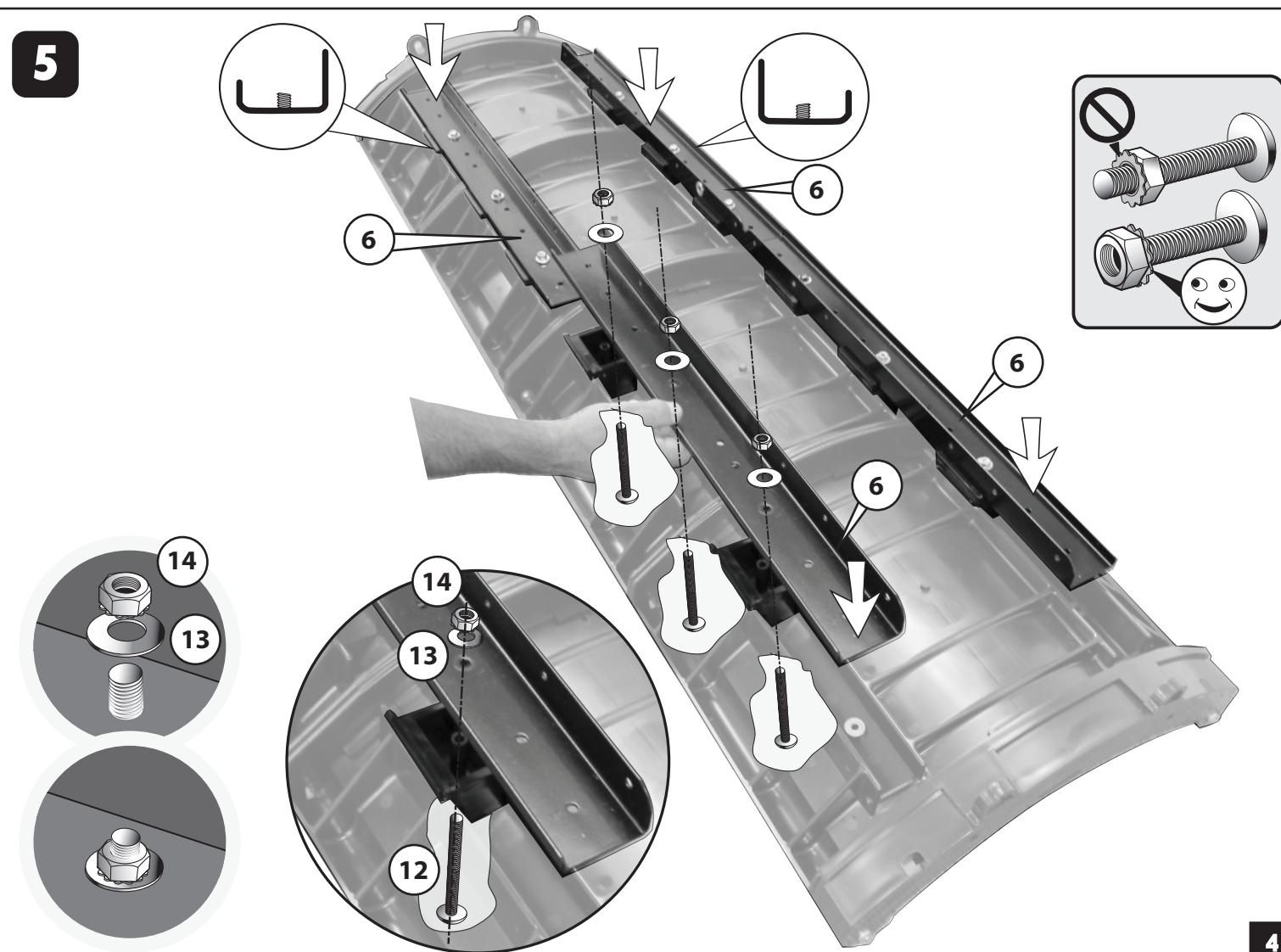



5

8

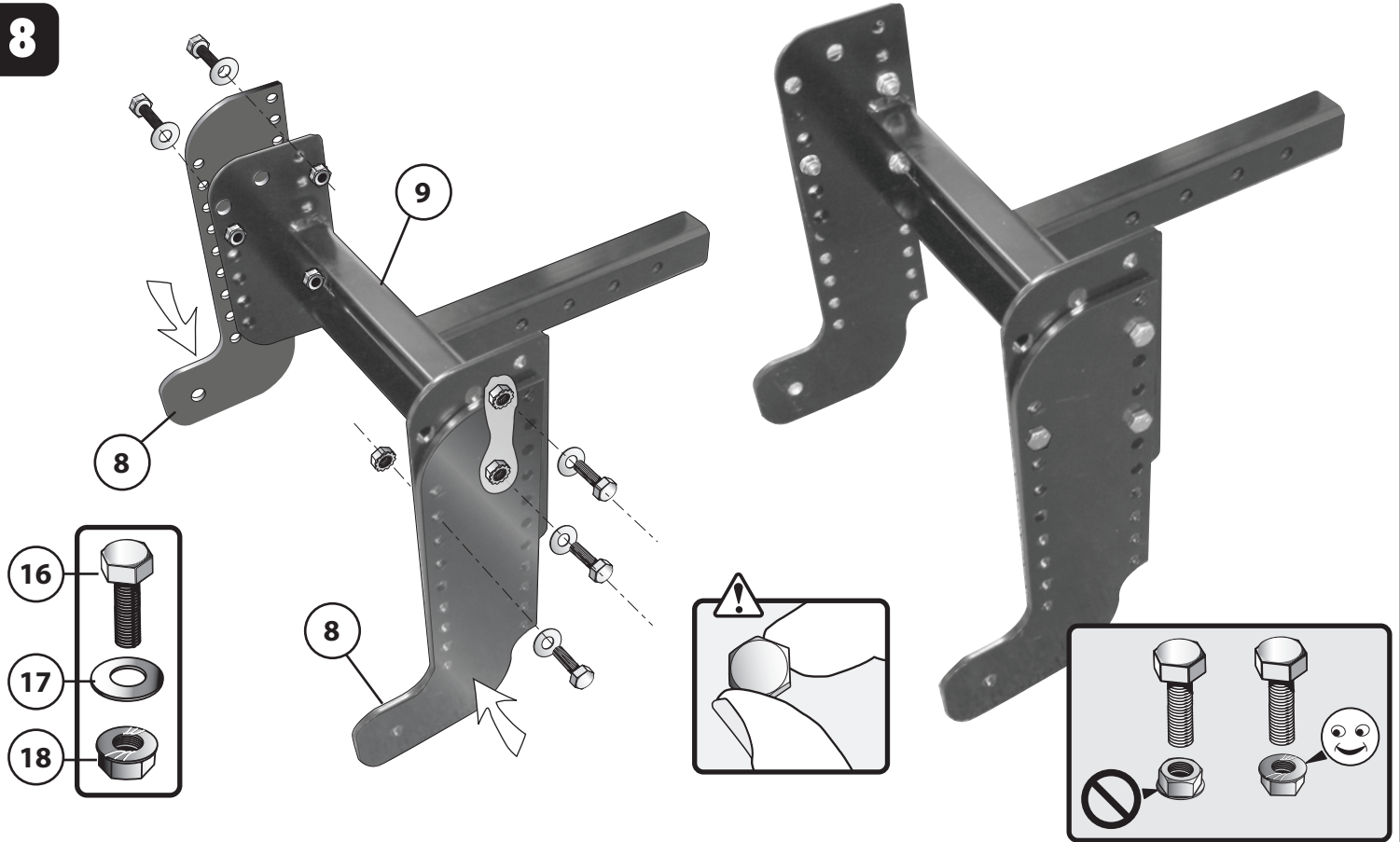

9

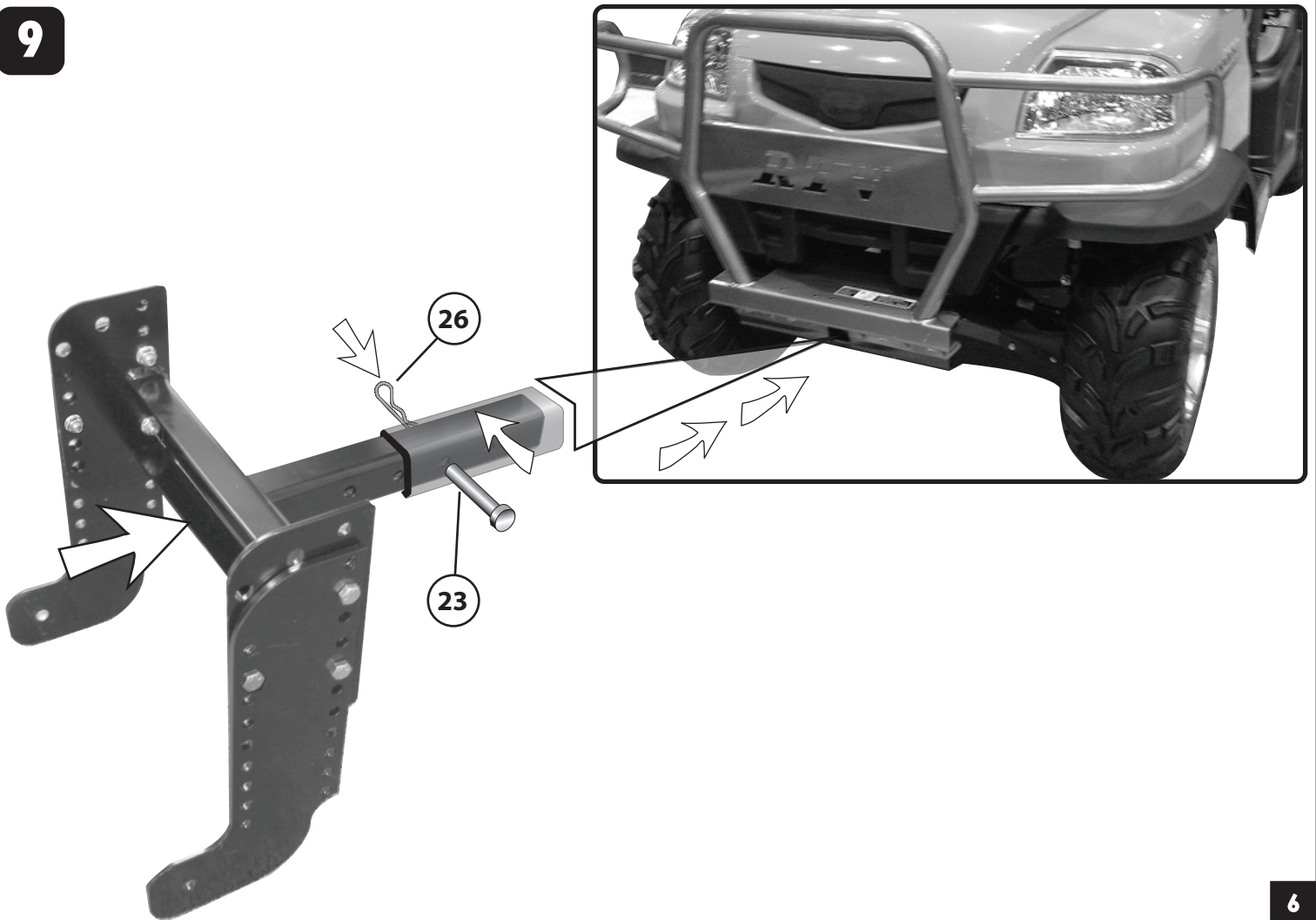



10

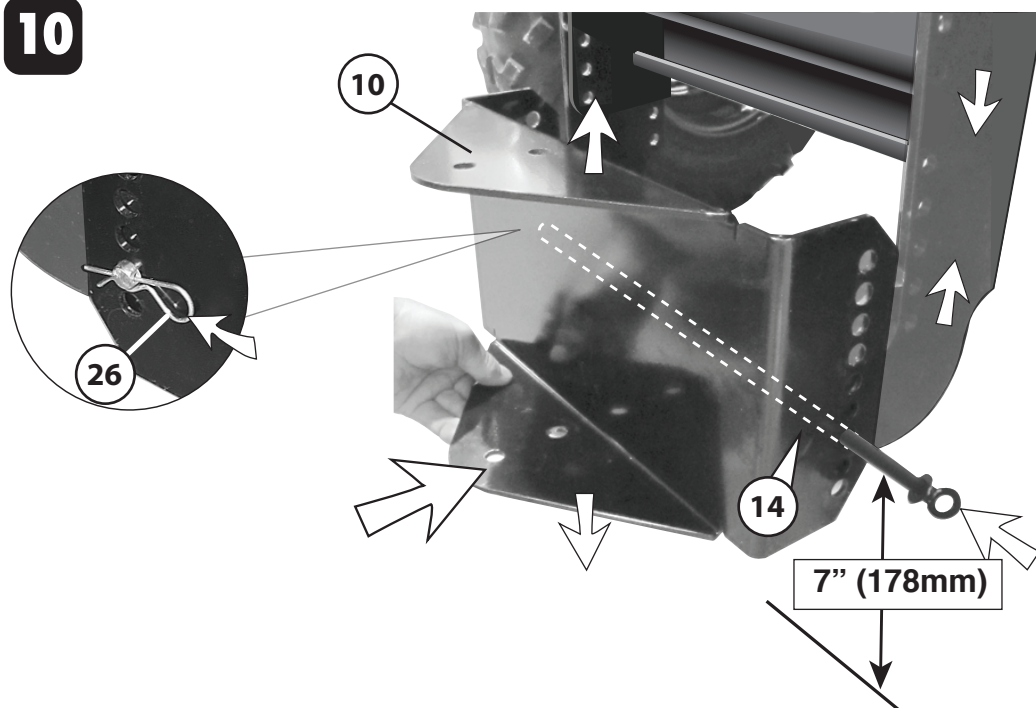

11

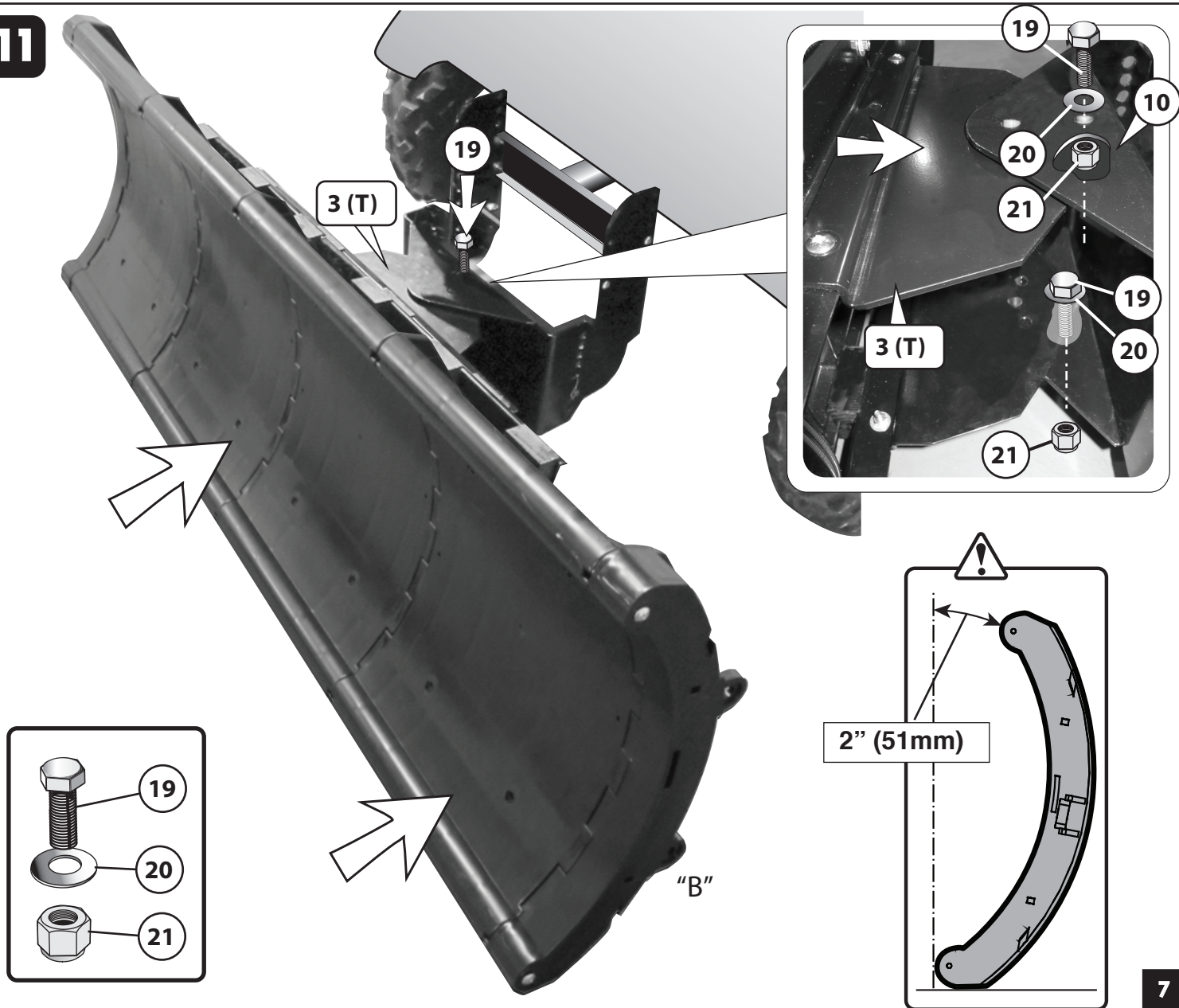

12

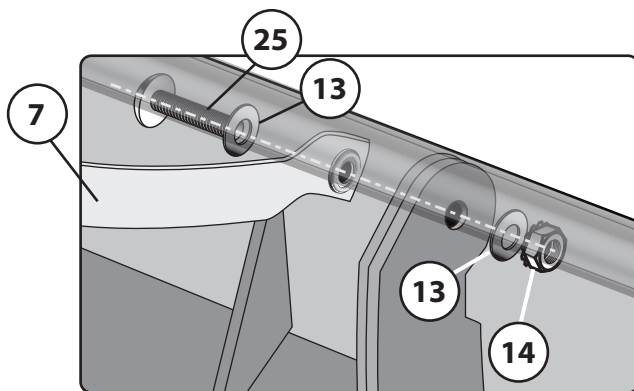

B

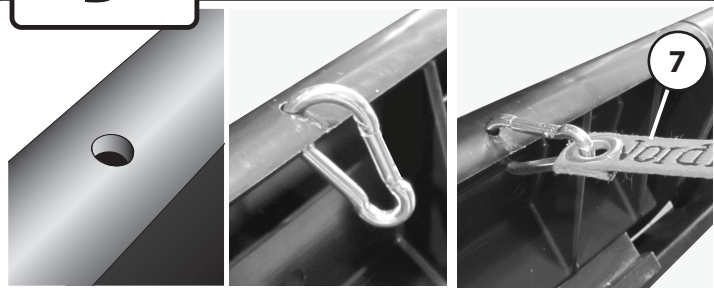

13

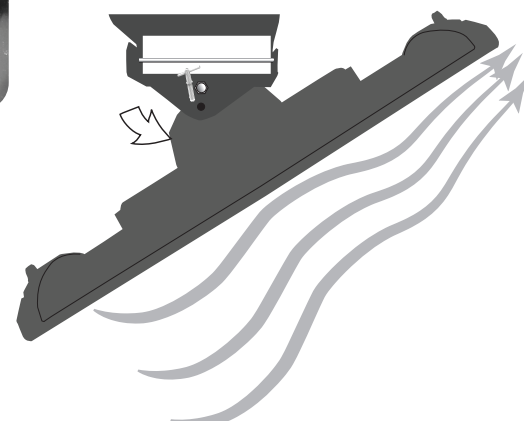
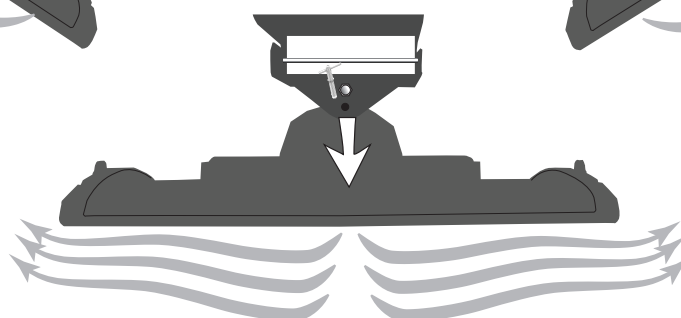
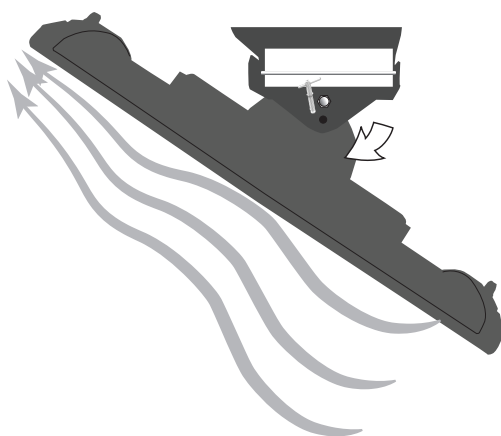
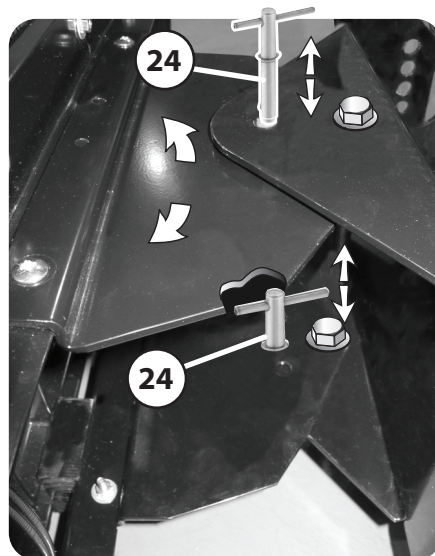



## ENGLISH

### **Safety:**

Read and understand the plow instruction manual before use.

Scan the QRC instructional videos on the first page or watch the videos on our website before use. ([www.nordicplow.com](http://www.nordicplow.com))

Always instruct other users before they use the plow.

### **Operation:**

#### **Risk of Injury**

- Never allow children to handle the plow.
- Never allow anyone to walk beside or sit on the plow when in use.
- **Never operate the plow over 2 to 3 mph. Keep a slow steady speed.**
- If you hit an obstruction, immediately stop the vehicle and reverse direction.
- Keep the strap secured near steering column to keep it clear of front axles.

### **Instruction Clarification:**

**STEP 8:** Assemble these nuts and bolts loosely by hand until you achieve the desired 7inch (178mm) distance from the ground to the axle hole as shown in Step 10. Then fully tighten.

**STEP 9:** You may need to purchase separately a hitch enlarger or reducer to fit our hitch.

**STEP 11:** Before attaching the blade to the bracket, make sure

the top pivot plate (Part#3) is on top. Do not over tighten the lock nuts (Part#21) – there should be some wiggle room to allow for easy placement of the T-Handle (Part#24) into the multi-position holes.

**STEPS 12:** We show two optional methods to attach the strap to the blade:

1. Remove one of the upper bolts (Part#15) from the top of the plow and replace it with a longer bolt (Part #25). Place strap between washer and blade as shown.
2. Drill a hole in the top center of blade and attach a clip as shown in **Fig. B** (not included). Attach the strap or winch hook if available.

### **FAQ's**

#### **How long will the plow last?**

The lightweight design and rounded edge technology significantly reduces friction and wear of the blade. The bottom edge will show signs of pits and scratches but will not degrade the blade. In addition, each blade is reversible for added longevity.

#### **Where is the cutting edge?**

The Nordic Plow works extremely well without a cutting edge. The Plows angle combined with its weight and that of the machine and operator provide significant force tight to the ground. This force allows for a clean sweep of snow, slush, mulch, dirt, etc. The plow may not pick up hard, packed down snow or ice.

### **Can I use it on uneven surfaces or grass?**

Yes – our rounded edge blade can be used on paver bricks, sidewalks, grass, gravel and most uneven surfaces without causing damage to the blade or surface being plowed.

### **Will the plow leave marks on the pavement?**

The Nordic Plow will not leave marks on your driveway, unlike traditional steel plows that can leave rust and scratches on the pavement.

### **Trouble Shooting & Tips**

#### **Blade is not flush to ground:**

In the angled position, the blade will not be flush to the ground if the top pivot and bottom pivot plates are reversed.

#### **The blade flips forward when plowing:**

Adjust the boots and axle so that the axle is 7" (178mm) from the ground.

#### **T-Handle Hard to Insert:**

The top and bottom pivot bolt must be loosened to allow for some movement in the metal plates.

#### **The blade is heavy to lift with strap during operation:**

After you have pushed the snow or material, reverse the machine to clear the blade of the material before lifting the blade with the strap.

#### **Belly Plate Heavy to Install:**

Prop the belly plate up with wood or car jacks under frame of machine – then line up bolts and attach.