

Assembly Instructions

CM-BN6681

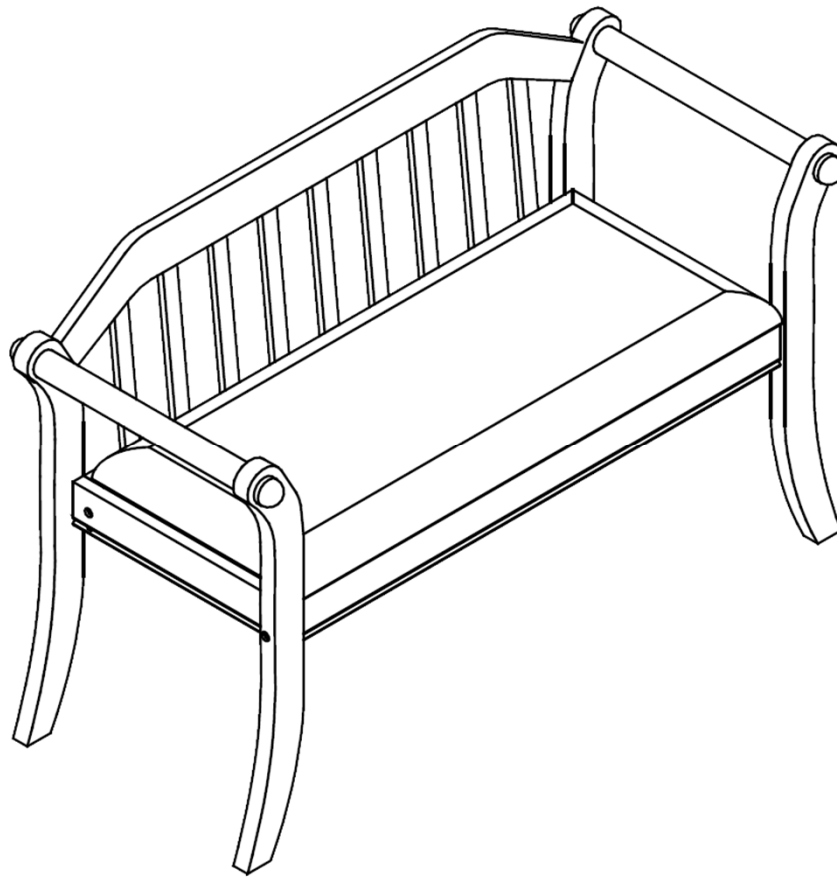

ASSEMBLY RATING

The Assembly Rating is a 5-point system that shows the degree of effort needed in assembling a specific product (with 1 being easy and 5 being difficult). For some products, two persons are recommended.

EASY  DIFFICULT

Tools Required for Assembly:

Allen Wrench



(Included)

Phillips Screwdriver



(Not Included)

ASSEMBLY & CARE ADVICE

FOR YOUR FURNITURE TO LAST, CORRECT ASSEMBLY AND PROPER MAINTENANCE ARE NECESSARY.
PLEASE FOLLOW THE INFORMATION PROVIDED BELOW TO FULLY ENJOY YOUR FURNITURE.

BASIC ASSEMBLY TECHNIQUES

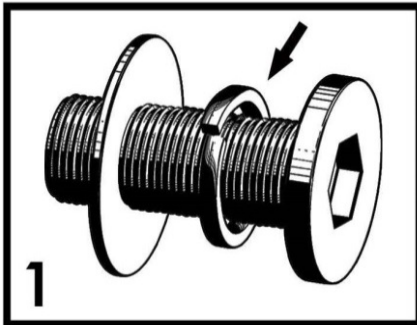

1
When lock or spring washer is used in an assembly, please make sure the lock or spring washer is placed between the larger flat washer and the head of the screw or bolt.

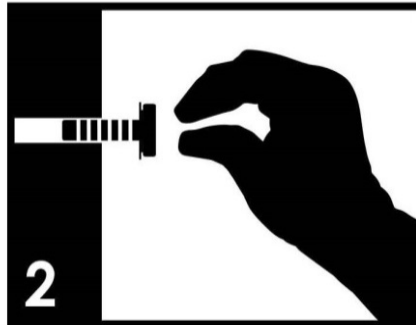

2
Position each part correctly and insert screws or bolts into their respective holes by hand tighten or using the proper hand tool. Only tighten when step is completed or when instructed to do so.

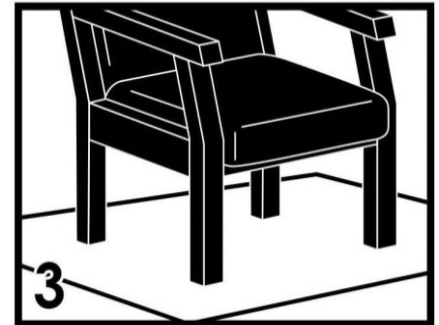

3
Use cardboard or carpet area when assembling furniture to prevent scratches. Make sure the furniture rests on a flat and level surface with each leg evenly touching the floor.

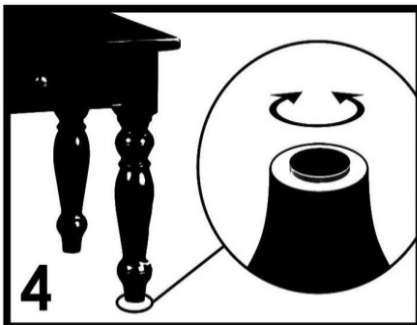

4
Some furniture comes with height adjustment knobs underneath each leg. To lower or to raise each leg, you need to turn clockwise or counterclockwise, respectively.

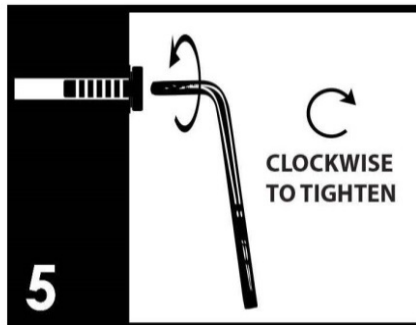

5
Make sure all parts are properly aligned, then use the appropriate hand tool to completely tighten the bolts or screws. Do not use power tools and do not overtighten.

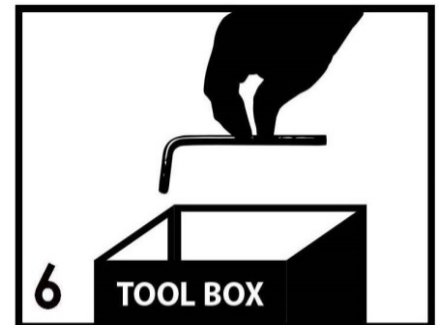

6
Save the instructions and store the Allen wrench or any supplied tool for later maintenance. After two weeks, check and tighten any loose hardware and repeat again every six months thereafter.

IT IS THE USER'S RESPONSIBILITY TO MAINTAIN THE FURNITURE. THE HARDWARE MAY LOOSEN OVER TIME AND MAY CAUSE THE FURNITURE TO BE WOBBLY AND UNABLE TO SUPPORT ITS INTENDED WEIGHT CAPACITY. THIS MAY LEAD TO COLLAPSE AND MAY CAUSE SERIOUS INJURY.



FAILURE TO FOLLOW THE GUIDELINES ABOVE MAY
RESULT IN INJURY AND/OR PROPERTY DAMAGE.

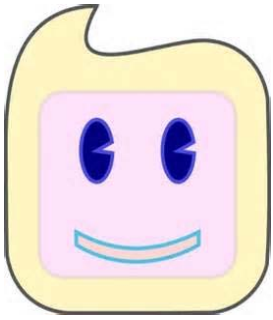

Before you begin, please read Page 2 of "Assembly and Care Advice".

And remember, do not tighten until each step is completed or instructed.

MD

Parts List

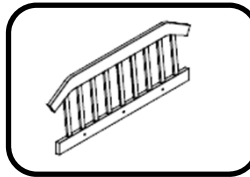

#1 x 1 pc
Backrest



#2 x 1 pc
Left Arm

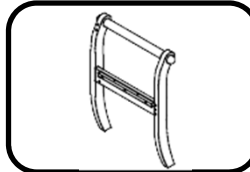

#3 x 1 pc
Right Arm

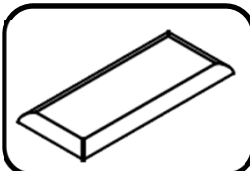

#4 x 1 pc
Bench Cushion

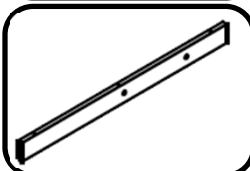

#5 x 1 pc
Rear Support Rail

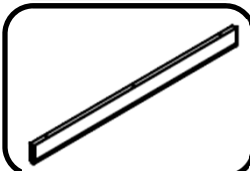

#6 x 1 pc
Front Support Rail

Hardware List

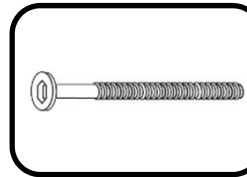

#A x 4 pcs
Bolt 1/4"x2-1/2"

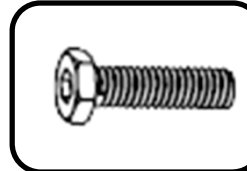

#B x 5 pcs
Bolt 1/4"x1-3/16"

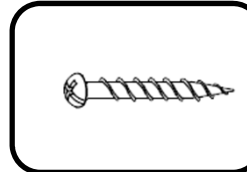

#C x 10 pcs
Screw

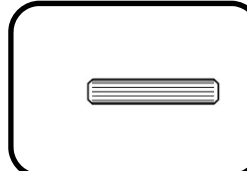

#D x 10 pcs
Wood Dowel

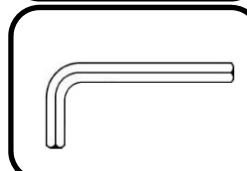

#E x 1 pc
Allen Wrench

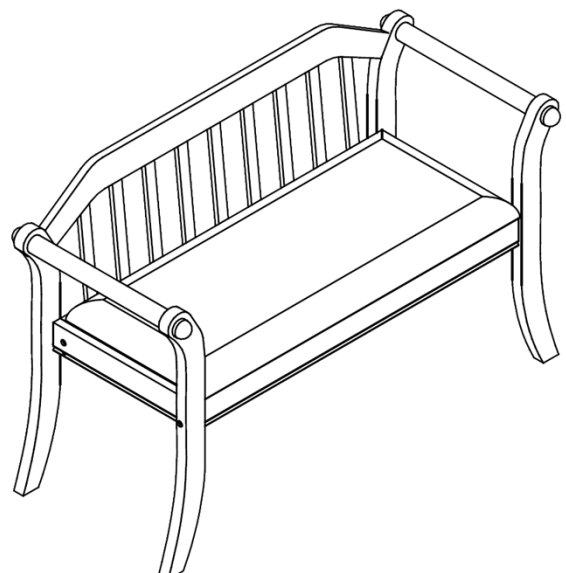

Step 1

Insert two wood dowels (#D) onto the backrest (#1), four wood dowels (#D) onto the rear support rail (#5) and four wood dowels (#D) onto the front support rail (#6).

#D x 10 pcs

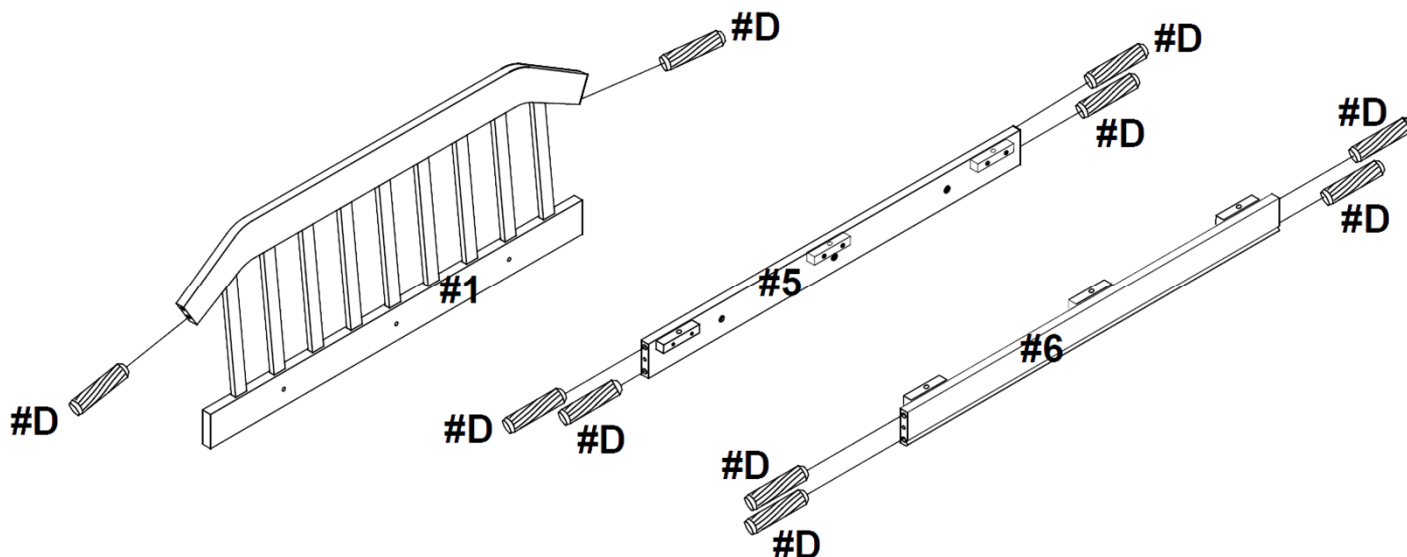

Step 2

#A x 4 pcs

Note: Right and left is determined by standing in FRONT of the bench in its upright position.

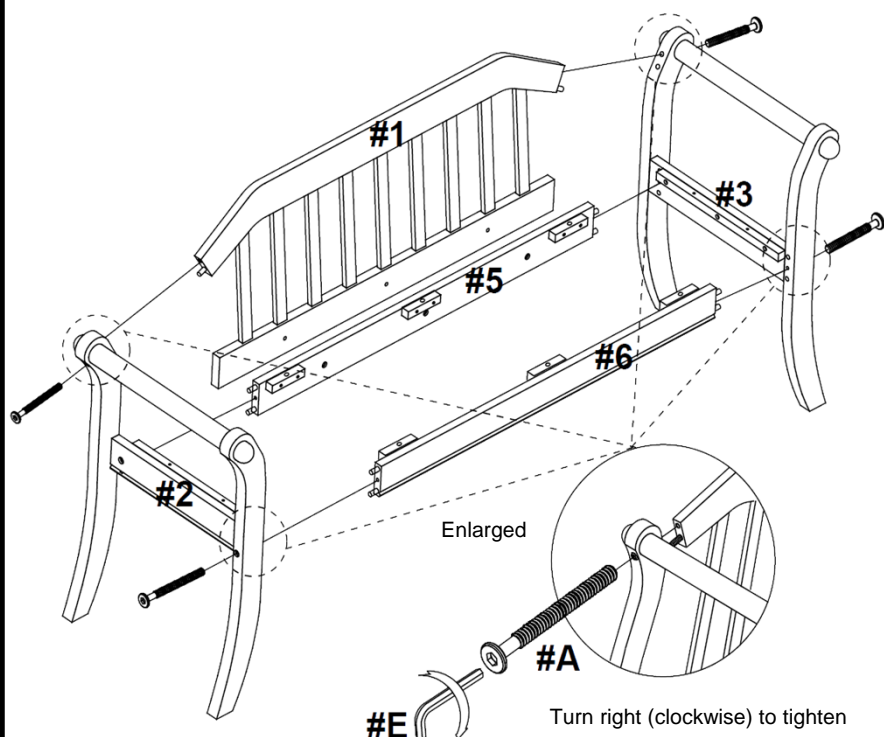

- I. Insert the backrest (#1) onto the left side arm (#2) and secure the bolt (#A) through the left arm (#2) using the Allen wrench (#E) to lock it with the backrest (#1).
- II. Insert the front support rail (#6) onto the left arm and secure the bolt (#A) through the left arm (#2) using the Allen wrench (#E) to lock it with the front support rail (#6).
- III. Insert the rear support rail (#5) onto the left side arm (#2).
- IV. Repeat the above process to assemble the right arm (#3) onto the backrest (#1), the front support rail (#6) and the rear support rail (#5).

Step 3

#B x 5 pcs

- I. Align the bench cushion (#4) onto the assembled parts. Insert 3 bolts (#B) onto the rear support rail (#5) and using an Allen wrench (#E) to lock them down with the bench cushion (#4).
- II. Insert a bolt (#B) onto the left arm (#2) and using an Allen wrench (#E) to lock it down with the bench cushion (#4). Repeat the same for the right arm (#3).

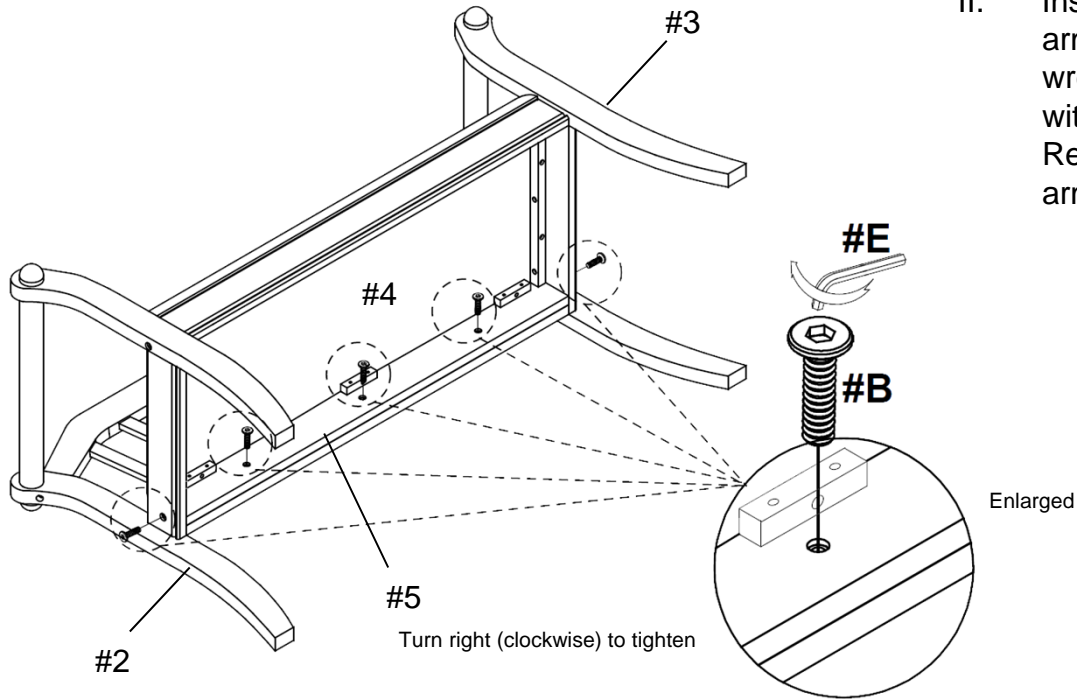

Step 4

- I. Insert 6 screws (#C) onto the brackets of the rear support rail (#5) AND the front support rail (#6) and using a Phillips screwdriver to secure them down with the bench cushion (#4).
- II. Insert 2 screws (#C) onto the left arm (#2) and using a Phillips screwdriver to secure them down with the bench cushion (#4).
- III. Repeat process II to secure the right arm (#3) onto the bench cushion (#4).

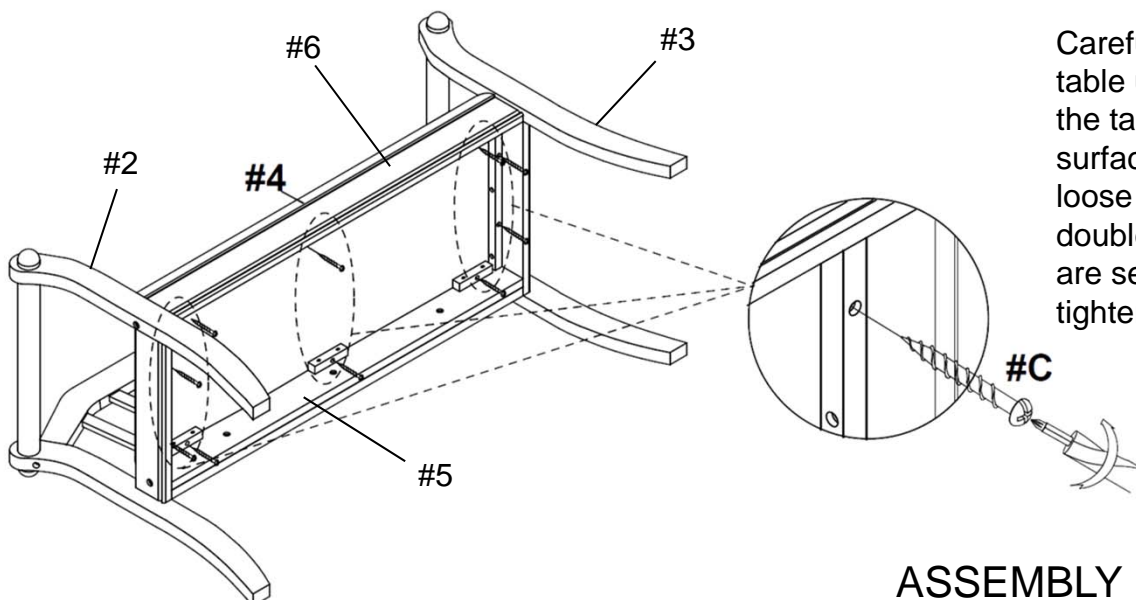

Carefully turn the completed table upright. Make sure the table is rested on a flat surface and it does not feel loose or wobbly. If it does, double check that the bolts are secured and properly tighten.

ASSEMBLY IS COMPLETED