



MOTION

Automobile Air Purification

Owner's Manual

2 WELCOME

Thank you for your purchase of the pureAir MOTION. The technology in the unit is designed to clean your vehicle's breathing space of smoke, bacteria, viruses, VOC's (Volatile Organic Compounds), dust and other particulates. With minimal cleaning and maintenance, you can keep MOTION in its optimal working condition.

Packaged Materials:

- 1 Motion Air Purifier
- 1 12V DC Power Cable
- 1 Owner's Manual

Records:

Purchase Date: _____

Model Number: _____

Serial Number: _____

Retailer Name: _____

Retailer Phone: _____

TABLE OF CONTENTS 3

Uses & Features	4
Warnings	5
Product Introduction / Control Panel and Unit Top	6
Product Introduction / Unit Rear	7
Setup	8 - 9
Operation	10 - 11
Maintenance	12 - 14
Cleaning	15 - 16
Product Specifications	17
Warranty Information	18

4 USES & FEATURES

NOTE: MOTION is not a medical device and should not be used to alleviate any respiratory issues you may have. Please consult your doctor before using the MOTION if you are worried that the machine could cause adverse effects.

Uses

- Clean and removes particulates from your breathing space
- Significantly reduces bacteria, viruses, & VOC's in the air

Features

- Cleanable Unit Body and Filter
- Replaceable ION Generator
- Quiet Operation
- Convenient Design
- 4 Hour Auto Shut-Off

NOTE: For your safety, please read through these warnings before using MOTION.



Do not change settings on the unit while driving.



Do not place in a location that will obstruct your view while driving.



Do not block either air vent.



Be careful with liquids near the unit.



Unplug this unit before cleaning or maintenance.



Unplug this unit when not in use.



Mechanical or Electrical Maintenance must be performed by the manufacturer or licensed professional. Failure to adhere to this will void your warranty.



If there is any damage to the unit or wiring, stop using immediately and contact the manufacturer for repairs or replacement.

6 PRODUCT INTRODUCTION / Control Panel & Unit Top

- 1 Air Vent Out
- 2 Mode/Fan Speed
- 3 Fan Speed Indicator
- 4 Ion Generator Replacement Light
- 5 Ion Generator Lifetime Reset
- 6 Clean Filter Light

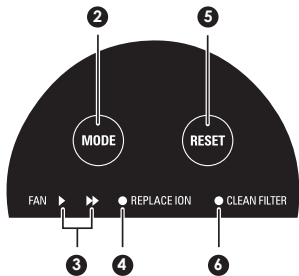
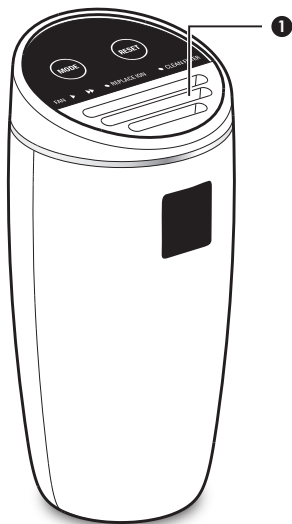

PRODUCT INTRODUCTION / Unit Rear 7

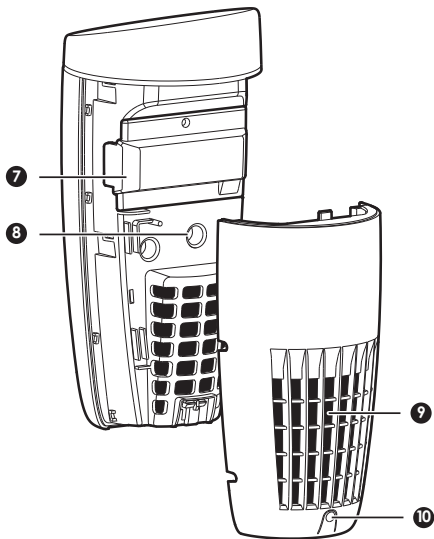

- 7 Ion Generator
- 8 DC Power Plug In
- 9 Filter
- 10 Rear Cover Release
- 11 DC Power Adapter

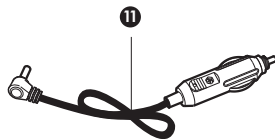

8 SETUP



- 1 Push on the Rear Unit Cover Release Button and slide the plate down and off the unit.

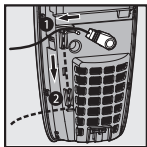

- 2 Place the DC Plug in the DC Power Plug In and situate the cord in one of its two cable ports along the side of the unit.

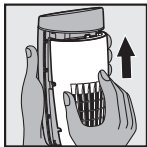

- 3 Replace the Rear Unit Cover.



- 4 Secure the Power Plug into the Vehicle's 12V Outlet.

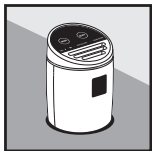

- 5 Place the unit in a cup holder or another secure location that will not distract the driver.

10 OPERATION

NOTE: To improve the Ion Output, use MOTION in conjunction with your vehicle's Air Conditioning.

WARNING: Do not change settings on MOTION while driving your vehicle.

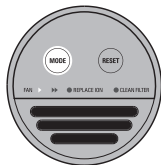

Push the Mode Button once. The unit will now run in **Low Output Mode**. (Denoted by One Arrow on Fan Speed Indicator)

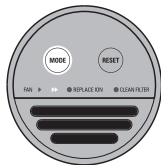

Pushing the Mode Button again will change to **High Output Mode**. (Denoted by Two Arrows on Fan Speed Indicator)



Pushing the Mode Button a third time will turn the unit **OFF**.

NOTE: MOTION will save the last mode used when you turn your car OFF and back ON.

NOTE: MOTION has an automatic shut-off feature that will power the unit down after 4 hours; this is to prevent a battery drain if your outlet is not controlled by the vehicle's ignition.

12 MAINTENANCE

Your MOTION will need maintenance from time to time in order to keep it functioning at its best ability.

WARNING: Remove the Power Plug from the Vehicle's 12V Outlet before performing any maintenance. Failure to do so could result in an electrical shock.

Ion Generator Replacement Indicator - 16,000 Hours Estimated Lifetime

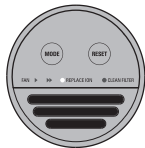

The Ion Generator Replacement Indicator will light up to notify you if the Ion Generator is damaged or in need of replacement. If a replacement Ion Generator is needed, contact your retailer or the manufacturer at www.GreenTechEnv.com.



- 1 Push on the Rear Cover Release Button and slide the Rear Cover down and off the unit.

MAINTENANCE 13

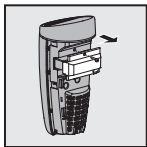

- 2** Remove the screw holding the Ion Generator in place.

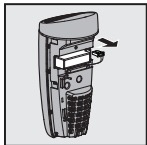

- 3** Disconnect the Power Cable and Remove the Ion Generator.

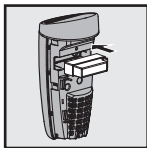

- 4** Replace the Ion Generator and the Screw that holds it in place.

14 MAINTENANCE (continued from page 13)

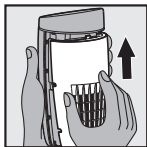

- 5 Replace the Rear Cover and plug the unit back into the Vehicle's 12V Outlet.



- 6 Turn the MOTION on and hold the Reset Button for 3+ Seconds.
The Ion Generator Indicator Light will flash twice, turn off, and begin monitoring the new Ion Generator.

CLEANING 15

Your MOTION will need cleaning from time to time in order to keep it functioning to its best ability.

WARNING: Remove the Power Plug from the Vehicle's 12V Outlet before performing any cleaning.
Failure to do so could result in an electrical shock.

WARNING: Damage may occur while using harsh chemical cleaners to clean your unit.
For best results, use a damp towel to wipe the unit down.



- 1 Push on the Rear Cover Release Button and slide the Rear Cover down and off the unit.

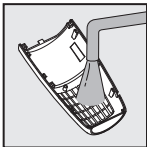

- 2 Wash the Rear Cover/Filter under a faucet. Scrub thoroughly.

16 CLEANING (continued from page 15)

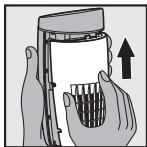

- 3 Dry and replace the Rear Cover.



- 4 Turn the MOTION on and hold the Reset Button for 3+ Seconds.
The Clean Filter Indicator Light will turn off.

PRODUCT SPECIFICATIONS 17

Model Number	PA-MOTION	
Voltage	12V DC .14 A	
Effective Area	3.6 m ³	
Dimensions	6.4" H (162 mm) x 2.8" W (72 mm) x 2.2" D (55 mm)	
Weight	8.64 oz. (245g)	
Modes	High	Low
Electrical Usage	2.3 W	1.8 W
Ion Output	25,000 Ions/cm ³	7,000 Ions/cm ³

18 WARRANTY INFORMATION

LIMITED WARRANTY INFORMATION

Your pureAir MOTION (Product) is warranted to be free from all defects in material and workmanship in normal household use for a period of **1 Year** from date of purchase. The warranty is granted only to the original purchaser. The warranty is subject to the following provisions:

Any damages or malfunctions caused by negligence, abuse, or use not in accordance with the Product Owner's Manual are not covered by this warranty. Likewise, any defects or damages caused by unauthorized service or the use of other than Genuine GreenTech Environmental Parts are not covered.

GreenTech Environmental, LLC will, at its option, repair or replace a defective Product or part(s) for the Product that is/are covered by this warranty. As a matter of warranty policy, GreenTech Environmental, LLC will not refund the customer's purchase price.

OBTAINING WARRANTY SERVICE

To obtain warranty service you must return the defective product along with proof of purchase to the GreenTech Environmental Authorized Service Center. All shipping costs submitted under this Warranty shall be borne by purchaser. Unless this Warranty is expressly renewed or extended by GreenTech Environmental, LLC, any repaired or replaced part of unit shall be warranted to the original purchaser only for the length of the unexpired portion of the original warranty. For the location of the nearest GreenTech Environmental Authorized Service Center or for other service information, please visit us online at:

www.GreenTechEnv.com/Service

Before any product is sent for service, the customer should contact the GreenTech Environmental Service Center to obtain a Return Merchandise Authorization (RMA) Number. This RMA Number should be clearly written on the box before shipping. All components/parts including the remote (if applicable), manuals, and original packaging should be included in the return if available.

FURTHER LIMITATIONS AND EXCLUSIONS ARE AS FOLLOWS

Any warranty that may be implied in connection with your purchase or use of the Product, including any warranty of merchantability or any warranty for Fitness For A Particular Purpose is limited to the duration of this warranty. Some states do not allow limitations on how long an implied warranty lasts, so the above limitations may not apply to you.

Your relief for the breach of this warranty is limited to the relief expressly provided above. In no event shall GreenTech Environmental, LLC be liable for any consequential or incidental damages you may incur in connection with your purchase or use of the Product. Some states do not allow the exclusion or limitation of incidental or consequential damages, so the above limitation or exclusion may not apply to you.

This Warranty gives you specific legal rights, and you may also have other rights which vary from state to state.

REGISTRATION

Please register your Product within 10 days of purchase by visiting www.GreenTechEnv.com/Warranty. Registering your new GreenTech product entitles you to the most up-to-date GreenTech warranty and promotion information.



GREENTECH
ENVIRONMENTAL

www.GreenTechEnv.com