

Installation Instructions

New Add On Shower

For Clawfoot Tub

includes Rectangular Shower Rod

Tools required for installation (not included):



Electric Drill

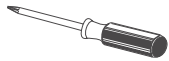

Screwdriver (Phillips Head)



Adjustable Wrench

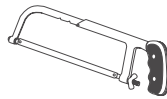

Hacksaw

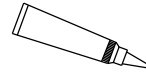

Silicone Sealant

Installation Instructions:

1. Turn off water supply and remove existing faucet .
2. Apply a bead of Silicone Sealant or plumber's putty to the back of the new faucet (1) and place it into position Attach locknuts (2) to the thread shanks , Do not over tighten nuts as this may damage your tub .
3. Reconnect existing supply nosecone pieces into faucet shanks , Tighten coupling nuts securely .
4. Thread riser coupling (4) onto one end of the lower riser tube (3) and tighten , thread opposite end of the lower riser tube(3) into faucet riser connector nut (5) and tighten .No thread sealing tape required .
5. Put together shower frame assembly :
 - a) Slide the Ceiling support loop (6) onto one end of half tube (7) .
 - b) Connect the two half tube (7) by use the tube connecting piece (16) , squeeze the tube connecting slightly and insert 1-1/2" inch into one end of the half tube (7) , use the same process and connect the second half tube (7) , the two half tubes should be meet , tighten with the wood screws provided .
 - c) Slide the other two ends of the half tube (7) into Rod Holder assembly (10) Tighten the two setscrew provided .
6. Thread the Ceiling support Rod (15) into the Ceiling support Flange (14) ,and measure the installation length of the Ceiling Support Rod (15) , Cut the Ceiling Support Rod (15) to be proper length , insert the Ceiling Support Rod (15) into the Ceiling Support Loop (6) , secure with the provided set screw.
7. Thread the Wall Bracket Rod (13) into the Ceiling support Flange (14) ,and measure the installation length of the Wall Bracket Rod (13) , Cut the Wall Bracket Rod (13) to be proper length , insert the Wall Bracket Rod (13) into the Rod Holder assembly (10) , secure with the provided set screw.

Note: Ceiling support rod and Support rod may be cut off as required for proper length

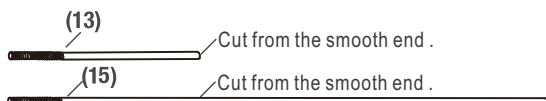

8. Thread the bushing out off the Upper Riser (11) ,apply thread sealing tape to face bushing and attach the shower head (12) and tighten.

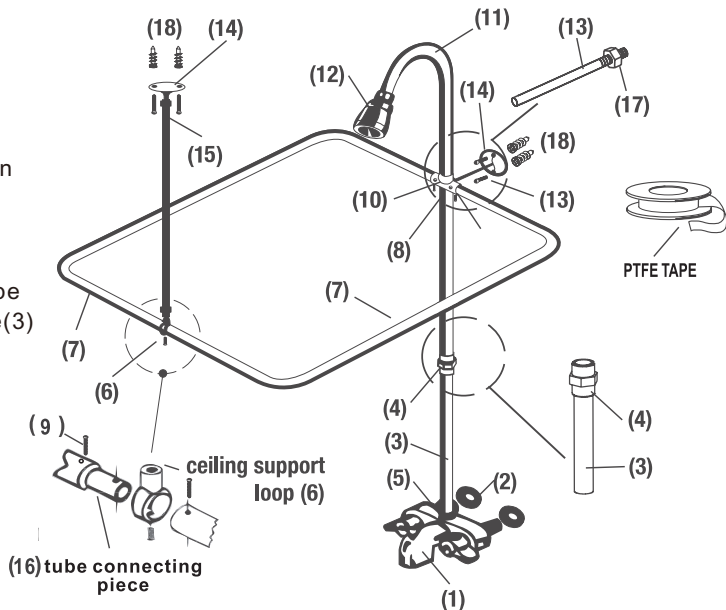

9. Slip the Upper Riser (11) into the Rod Holder assembly (10) and thread Upper Riser assembly to Lower Riser using riser coupling (4) , No thread sealing tape required .
10. Move the complete shower frame assembly along the Upper Riser (11) until Ceiling Support Flange (14) reaches the ceiling and Wall .
11. Fasten Support Flanges (14) to the ceiling and wall use the anchor wood screws provided with the flanges.

Note: When fastening flanges to drywall (plastic board) or hollow wall , use plastic anchors provided ,install plastic anchors into the wall before inserting the screws. If installation requires that the holes be re-drilled with a masonry type drill bit and that Toggle Bolt Style Anchors (not supplied) are used.

12. Tighten all the screws on the loop and shower rod holder. Tighten all Jam nuts (17) on the threaded rods.
13. Turn on water and check for leaks at all connectors.



Item no.:11123

Installation Instructions

Add-A-Shower

Bathcock Type

Tools required for installation (not included):



Electric Drill

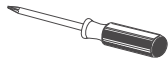

Screwdriver (Phillips Head)



Adjustable Wrench

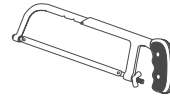

Hacksaw



Silicone Sealant

Installation Instructions:

1. Turn off water supply .
2. Remove existing bath faucet and riser by unthreading faucet locknuts and supply coupling nuts from back of tub.
3. Apply a bead of Silicone Sealant or plumber's putty to the back of the new faucet (1) and place it into position ,Attach locknuts (2) to the thread shanks , Do not overtighten nuts as this may damage your tub .
4. Reconnect existing supply into faucet shanks. Tighten coupling nuts (not shown) securely.
5. Thread riser coupling (3) onto one end of the lower riser tube (4) and tighten , thread opposite end of the lower riser tube(3) into faucet riser connector nut (5) and tighten .No thread sealing tape required .
6. Slip the Upper Riser (7) into the Riser loop (8) and thread Upper Riser assembly to Lower Riser using riser coupling (3) , No thread sealing tape required .
7. Thread the Wall Bracket Rod (9) into the Flange (10) , and measure the installation length of the Wall Bracket Rod (9) , Cut the Wall Bracket Rod (9) to be proper length , insert the Wall Bracket Rod (9) into the riser loop (8) , secure with the provided set screw.

Note: Support rod may be cut off as required for proper length

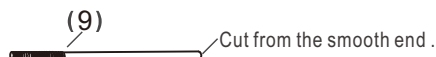

8. Thread the bushing out off the Upper Riser (7) , apply thread sealing tape to face bushing and attach the shower head (6) and tighten.
9. Move up the Wall Bracket Rod (9) to desired height.
10. Fasten Wall Bracket Flange to wall using the two wood screws supplied with the flange.

Note: When fastening flanges to drywall (plastic board) or hollow wall , use plastic anchors provided ,install plastic anchors into the wall before inserting the screws. If installation requires that the holes be re-drilled with a masonry type drill bit and that Toggle Bolt Style Anchors (not supplied) are used.

11. Turn on water and check for leaks at all connections.

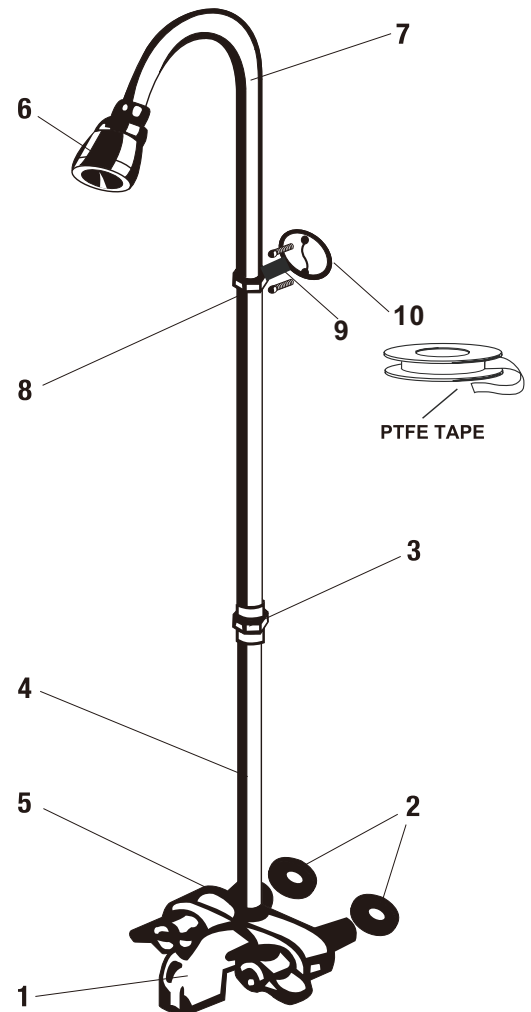

Item no.:11127

Installation Instructions

Add-A-Shower

Spout Type

Tools required for installation (not included):



Electric Drill

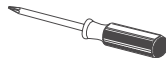

Screwdriver (Phillips Head)



Adjustable Wrench

Installation Instructions:

1. Turn off water supply and remove existing tub spout .
2. Install new diverter Spout (1) on to threaded stub out .
3. Thread riser Coupling (3) onto one end of the Lower Riser tube (2) and tighten , thread opposite end of the Lower Riser tube(2) into Spout Riser connector nut (5) and tighten .No thread sealing tape required .
4. Slip the Upper Riser (4) into the Riser bracket (6) and thread Upper Riser assembly to Lower Riser using riser coupling (3) , No thread sealing tape required .
5. Thread the bushing out off the Upper Riser (4) , apply thread sealing tape to face bushing and attach the shower head (7) and tighten.
6. Move up the Riser bracket (6) to desired height.
7. Fasten Riser bracket (6) to wall using the two wood screws supplied with the Riser bracket.

Note: When fastening flanges to drywall (plastic board) or hollow wall , use plastic anchors provided ,install plastic anchors into the wall before inserting the screws.If installation requires that the holes be re-drilled with a masonry type drill bit and that Toggle Bolt Style Anchors (not supplied) are used.

8. Turn on water and check for leaks at all connections.

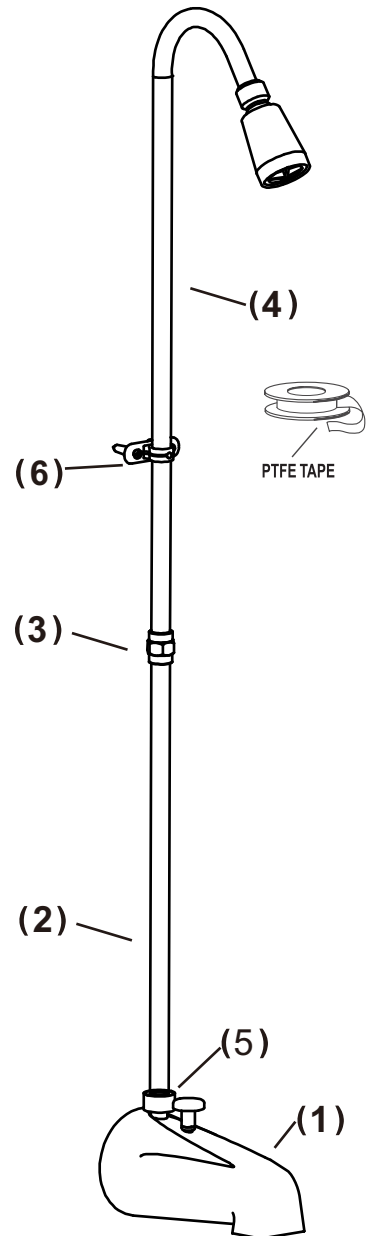

Item no.:11120