

## ASSEMBLY

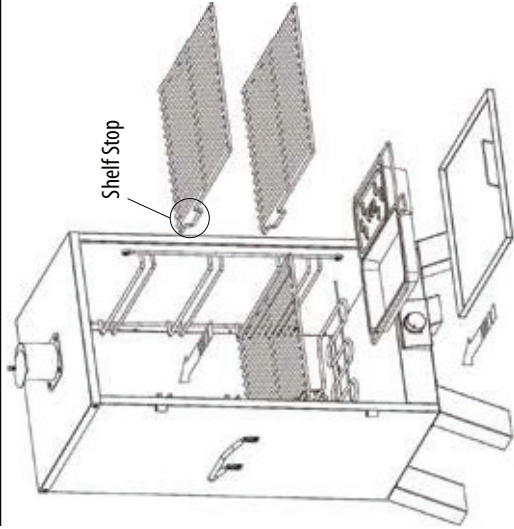

Install shelves with grates facing up and stops to the rear of the smoker.

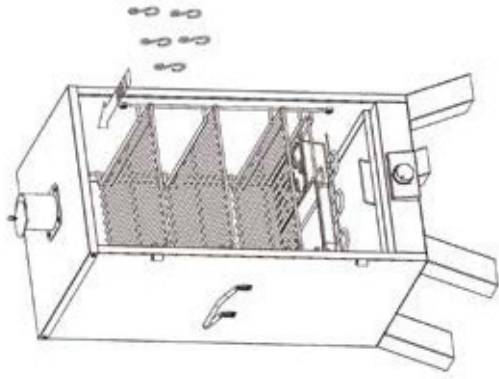

"S" hooks can be installed on the "U" brackets and used for hanging sausage casings.

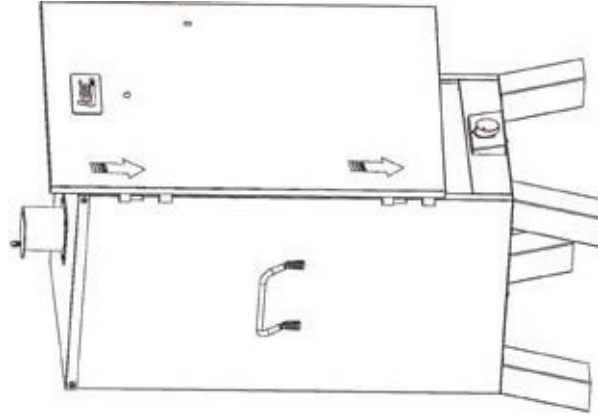

Replace the door by easily sliding it back onto its hinges.

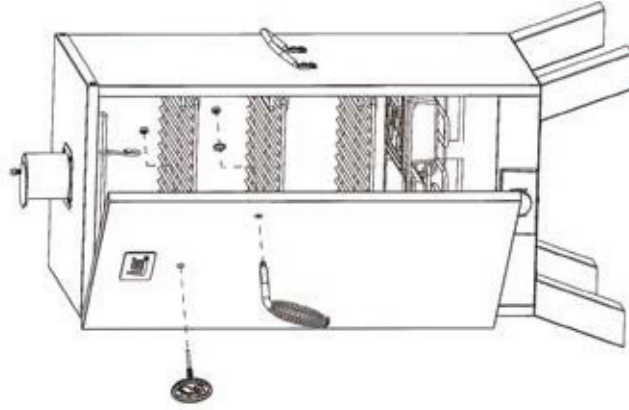

Install handle as pictured using the included washer and nut. Thermometer will come pre-assembled on the door.

## SAFETY WARNINGS

- Before assembling or using your new smoker, carefully read the instruction manual - including all of the following safety warnings and safety information on page 1.
- Failure to follow warnings and safety information could result in death, serious bodily injury, and / or property loss.
- Read and follow all safety warnings, assembly instructions, and use and care instructions before attempting to assemble or use your smoker.
- Some parts of the smoker may have sharp edges! Use protective gloves if necessary to protect against injury.
- Do not let children play near the smoker or operate smoker.
- Keep the area around the smoker clear of materials that can burn.
- Only use the smoker in a space that is well ventilated. Never use the smoker in an enclosed area like a garage or carport or under a porch or covered patio, or under any surface that can catch fire.
- Use smoker at least 3 feet from any wall or surface. Maintain a 10 foot clearance from objects that can catch on fire.
- **WARNING: DO NOT USE CHARCOAL WITH THIS SMOKER!** This smoker is not designed to be used with charcoal. Using charcoal with this smoker will void your warranty, may result in fire, create an unsafe condition and may damage the smoker or personal property.
- For best performance of your smoker use of an extension cord is not recommended.
- However, if it is necessary to use an extension cord **follow these steps for your safety:**
  - Use an UL approved, outdoor rated cord with a 3 prong grounding plug that is rated for 15 amps or more. Extension cord must be marked with a "W" (weather approved) and have a tag that states "suitable for use with an outdoor appliance".
  - Use the shortest cord required to accomplish the job. Do not connect 2 or more extension cords together (12 or 14 gauge extension cord of 50' or less is acceptable).
  - Keep connections dry and off the ground. Do not allow the cord to hang over edge of a table and do not place in walking path where it could be tripped over.



### WARNING

#### CALIFORNIA PROPOSITION 65

This product can expose you to chemicals including carbon monoxide from wood chips or dust, which is known to the State of California to cause cancer or other reproductive harm. For more information, go to [www.P65Warnings.ca.gov](http://www.P65Warnings.ca.gov).

## ASSEMBLY

- Check the box and make sure you have all parts and hardware listed on the next page (4). If parts are missing or damaged, please contact Customer Service for assistance at (877)536-7763, 8a.m.-6p.m. EST.
- Separate and identify all parts. You will need a Phillips head screwdriver and an adjustable wrench. We recommend using the bottom of the corrugated box as an assembly pad. **Be sure to remove any labels that are on the smoker before attempting to use.**
- For ease of assembly, we recommend assembling the smoker upside down on a sturdy table. Be sure to use the corrugated box or other protective pad to protect both the table surface as well as the top panel of the smoker. Slide the door off of its hinges and set aside before turning the smoker upside down.