



OWNER'S MANUAL **A11705**

20 INCH 2 IN 1 POLE/HANDHOLD HEDGE TRIMMER



FOR SERVICE CALL: (USA)1-866-591-8921/(CANADA)1-514-885-0916

WARNING : To reduce the risk of injury, user must read this manual before assembling, operating and maintaining this unit. You are responsible for operating the product properly & safely.

Version: V1.20171106

WARNING!

READ ALL INSTRUCTIONS BEFORE OPERATING! Follow all instructions.

Save all warnings and instructions for future reference.

These instructions below are for your safety. Read them thoroughly before using. Familiarize yourself with them to reduce hazards like personal injuries and damage to property.

TABLE OF CONTENTS

Safety Rules.....	2
Symbols.....	7
Specifications.....	8
Know Your Product.....	9
Assembly.....	10
Starting And Stopping.....	12
Operation.....	13
Maintenance.....	17
Transport.....	19
Storage.....	20
Troubleshooting.....	21

SAFETY RULES

Working Area Safety

1. Keep the work area clean and well lit. Cluttered or dark areas invite accidents. Only use the product in daylight or good artificial light.



2. Do not operate the product in explosive atmospheres, such as in the presence of flammable liquids, gases or dust. Power tools create sparks which may ignite the dust or fumes.
3. Keep children and bystanders away while operating a power tool. keep them outside a 50-foot (15 m) radius, at a minimum. If you are approached, stop the unit immediately.

Electrical safety

1. Power tool plugs must match the outlet. Never modify the plug in any way Do not use any adapter plugs with grounded power tools. Unmodified plugs and matching outlets will reduce risk of electric shock.
2. Avoid body contact with grounded surfaces such as pipes, radiators, ranges and refrigerators. There is an increased risk of electric shock if your body is grounded.
3. Do not expose power tools to rain or wet conditions. Water entering a power tool will increase the risk of electric shock.
4. Do not abuse the cord. Never use

the cord for carrying, pulling or unplugging the power tool. Keep cord away from heat, oil, sharp edges or moving parts. Damaged or entangled cords increase the risk of electric shock.

5. When operating a power tool outdoors, use an extension cord suitable for outdoor use. Use of a cord suitable for outdoor use reduces the risk of electric shock.
6. If operating a power tool in a damp location is unavoidable, use a ground fault circuit interrupter (GFCI) protected supply. Use of a GFCI reduces the risk of electric shock.
7. The substitution of the plug or cable should be done by a qualified professional and repaired, if necessary, before you operate it again. We recommend that this product should be connected to residual differential.
8. Do not touch the unit, cords, switches, power source or plugs with wet hands.

Personal Safety

1. Stay alert, watch what you are doing and use common sense when operating a power tool. Do not use a power tool while you are tired or under the influence of drugs, alcohol or medication. A moment of inattention while operating power tools may result in serious personal injury.
2. This product is dangerous in the hands of untrained users.
3. Use personal protective equipment. Always wear eye protection. Protective equipment such as dust mask, non-skid safety shoes, hard hat, or hearing protection used for appropriate conditions will reduce personal injuries.

4. Avoid accidental starting. Ensure the switch is in the off-position before plugging in. Carrying power tools with your finger on the switch or plugging in power tools that have the switch on invites accidents.

5. Remove any adjusting key or wrench from a rotating part before turning the power tool on. A wrench or a key left attached to a rotating part of the power tool may result in personal injury.
6. Do not overreach. Keep proper footing and balance at all times. This enables better control of the power tool in unexpected situations.
7. Dress properly. Do not wear loose clothing or jewellery. Keep your hair, clothing and gloves away from moving parts. Loose clothes, jewellery, or long hair can be caught in moving parts.



WARNING: Read all safety warnings and all instructions. Failure to follow the warnings and instructions may result in electric shock, fire, and/or serious injury.

Power Tool Use And Care

1. Do not force the power tool. Use the correct power tool for your application. The correct power tool will do the job better and safer at the rate for which it was designed.
2. Do not use the power tool if the switch does not turn it on and off. Any power tool that cannot be controlled with the switch is dangerous and must be repaired.
3. Disconnect the plug from the power source from the power tool before making any adjustments, changing

accessories, or storing power tools. Such preventive safety measures reduce the risk of starting the power tool accidentally.

4. Store idle power tools out of the reach of children and do not allow persons unfamiliar with the power tool or these instructions to operate the power tool. Power tools are dangerous in the hands of untrained users.
5. Maintain power tools. Check for misalignment or binding of moving parts, breakage of parts and any other condition that may affect the power tools operation. If damaged have the power tool repaired before use. Many accidents are caused by poorly maintained power tools.
6. Keep cutting tools sharp and clean. Properly maintained cutting tools with sharp cutting edges are less likely to bind and are easier to control.
7. Use the power tool, accessories and tool bits etc. in accordance with these instructions, taking into account the working conditions and the work to be performed. Use of the power tool for operations different from those intended could result in a hazardous situation.

Hedge Trimmer Safety

Warnings:

1. Use both hands when operating the hedge trimmer. Using one hand could cause loss of control and result in serious personal injury.
2. Keep all parts of the body away from the cutter blade. Do not remove cut material or hold material to be cut when blades are moving. Make sure

the switch is off when clearing jammed material. Blades coast after turn-off. A moment of inattention while operating the hedge trimmer may result in serious personal injury.

3. Carry the hedge trimmer by the handle with the cutter blade stopped. Proper handling of the hedge trimmer will reduce possible personal injury from the cutter blades.
4. Hold the power tool by insulated gripping surfaces only, because the cutter blade may contact hidden wiring or its own cord. Cutter blades contacting a "live" wire may make exposed metal parts of the power tool "live" and could give the operator an electric shock.
5. Keep cable away from cutting area. During operation the cable may be hidden in shrubs and can be accidentally cut by the blade.
6. DANGER - Keep hands away from blade. Contact with blade will result in serious personal injury.

Service

Have your power tool serviced by a qualified repair person using only identical replacement parts. This will ensure that the safety of the power tool is maintained.

Vibration And Noise Reduction

To reduce the impact of noise and vibration emission, limit the time of operation as well as wear personal protective equipment.

The prolonged use of the product, exposes the client to vibrations that in extreme cases and through many hours of use of the product could cause the "white finger syndrome" also known as

Raynaud phenomenon, This causes a reduction in the tact of the fingers and their capacity to regulate temperature generating a lack of sensibility. This sickness could in extreme cases cause problems with the nerve endings.

The exposure to the vibrations is the cause of the white finger syndrome, To minimise this effect as much as possible, follow the following recommendations:

1. When working with the device, a certain level of noise cannot be avoided. Noisy work should be scheduled for hours, during which it is allowed by statute or other local regulations. Adhere to any applicable rest times and limit your working time to the necessary minimum time. For your personal protection and the protection of people nearby, suitable hearing protection must be worn.
2. Take the following points into account to minimize the vibration and noise exposure risks:
 - Only use the product as intended by its design and these instructions.
 - Always use gloves.
 - Always have your hands warm.
 - Ensure that the product is in good condition and well maintained.
 - Ensure that the cutting device is always sharp.
 - Use correct attachments for the product and ensure they are in good condition.
 - Keep tight grip on the handles/grip surface.
 - Maintain this product in accordance with these instructions and keep it well lubricated (where appropriate).
 - Plan your work schedule to spread any high vibration tool use across a longer

period of time. Take frequent breaks.

- If you detect any of the symptoms of the white finger syndrome, consult immediately with your doctor.

Residual risks

Even if you are operating this product in accordance with all the safety requirements, potential risks of injury and damage remain. The following dangers can arise in connection with the structure and design of this product:

1. Health defects resulting from vibration emission if the product is being used over long periods of time or not adequately managed and properly maintained.
2. Injuries and damage to property due to broken cutting attachments or the sudden impact of hidden objects during use.
3. Danger of injury and property damage caused by flying objects.



WARNING! This product produces an electromagnetic field during operation! This field may under some circumstances interfere with active or passive medical implants! To reduce the risk of serious or fatal injury, we recommend persons with medical implants to consult their doctor and the medical implant manufacturer before operating this product!

DOUBLE INSULATION

Double insulation is a concept in safety in electric power tools, which eliminates the need for the usual three-wire grounded power cord. All exposed metal parts are isolated from the internal metal motor components with protecting insulation. double-insulated tools do not need to be

grounded.

ELECTRICAL CONNECTION

This product has a precision-built electric motor. It should be connected to a power supply that is 120 V, AC only, (normal household current) 60 Hz. Do not operate this product on direct current (DC). A substantial voltage drop will cause a loss of power and the motor will overheat. If the product does not operate when plugged into an outlet, double-check the power supply.



WARNING: The double insulated system is intended to protect the user from shock resulting from a break in the tool's internal insulation. Observe all normal safety precautions to avoid electrical shock.



NOTE: Servicing of a product with double insulation requires extreme care and knowledge of the system and should be performed only by a qualified service technician. For service, we suggest you return the product to your nearest authorized service center for repair. Always use original factory replacement parts when servicing.

SAFETY RULES FOR EXTENSION CORD

Make sure your extension cord is in good condition. When using an extension cord, be sure to use one heavy enough to carry the current your product will draw. An undersized extension cord will cause a drop in line voltage resulting in loss of power and overheating. Table 1 shows

the correct size to use depending on cord length and nameplate ampere rating. If in doubt, use the next heavier gage. The smaller the gage number, the heavier the cord. To reduce the risk of disconnection of appliance cord from the extension cord during operating:

- I) Make a knot as shown in Table 1; or
- II) Use one of the plug-receptacle retaining straps or connectors described in this manual.

Table 1 Minimum gauge for extension cords				
Volts	Total length of cord in feet			
120V	25	50	100	150
Ampere rating more than-not more than	AWG			
0-6	18	16	16	14
6-10	18	16	14	12
10-12	16	16	14	12
12-16	14	12	Not recommended	

METHOD OF SECURING EXTENSION CORD

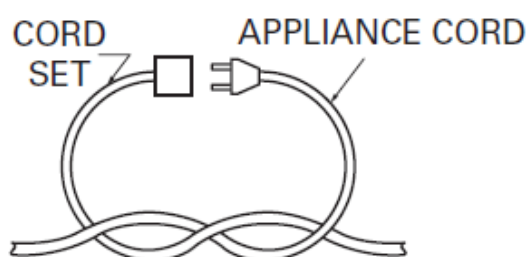

(A) TIE CORD AS SHOWN

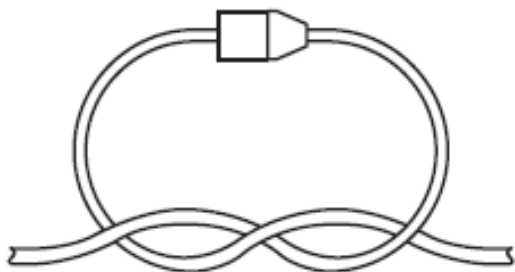

(B) CONNECT PLUG AND RECEPTACLE

NOTE: AWG = American Wire Gauge.

Ground Fault Circuit Interrupter (GFCI) protection should be provided on the circuit(s) or outlet(s) to be used with this unit. For an extra measure of safety, use receptacles with built-in GFCI protection.



WARNING! To reduce the risk of electric shock, use a Ground Fault Circuit Interrupter (GFCI) with a tripping current of 30 mA or less.



WARNING: Keep the extension cord clear of the working area. Position the cord so that it will not get caught on lumber, tools, or other obstructions while you are working with a power tool. Failure to do so can result in serious personal injury.



WARNING: Check extension cords before each use. If damaged replace immediately. Never use the product with a damaged cord since touching the damaged area could cause electric shock resulting in serious injury.

SYMBOLS

	SAFETY ALERT SYMBOL Indicates danger, warning or caution. May be used in conjunction with other symbols or pictographs.
	READ OPERATOR'S MANUAL WARNING: Read the operators manuals and follow all warnings and safety instructions. Failure to do so can result in serious injury to the operator and/or bystanders
	Wear protective non-skid boots with protective steel.
	Wear security gloves and use both hands to operate this tool.
	Wear ear protection WARNING: Loud noise can cause severe hearing loss. Wear ear protection when operating this unit.
	Wear eye goggles. Thrown objects can cause severe eye injury. Wear eye protection meeting current ANSI / ISEA Z87.1 standards
	Wear safety helmet! Wear head protection when operating this unit; falling objects can cause severe head injury. Use a full face shield when needed.
	Wear respiratory protection.

	Wear protective clothing
	DO NOT USE IN THE RAIN WARNING: Avoid dangerous environments. Never operate the unit in the rain or in damp or wet conditions. Moisture is a shock hazard.
	Danger! Keep hands away from sharp blades, Don't touch the blades when starting or while operating the unit.
	Unplug the product before doing any maintenance work on the product.
	Remove plug from the power source immediately if the cable is damaged or cut

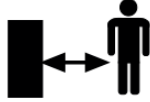
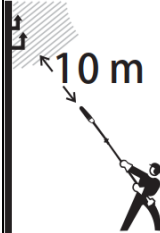
	DOUBLE INSULATED: Class II device .This device must not be earthed.
	WARNING: Keep all bystanders, especially children and pets, at least 50 feet (15 m) from the operating area. Objects thrown by the product could hit the user or other bystanders.
	Always beware of the danger from overhead electric-power line, keep a safe distance at least 10M(32.8ft) from the power line.

SPECIFICATIONS

Model	A11705
Engine	120V ~ 60Hz
Power	4.6Amp
Protection grade	IP20
Blade length:	20 inch
Cut capacity:	3 / 4inch(19mm)
Protection class	 / II
Weight	5.3kg(11.7lbs)

Know Your Hedge Trimmer

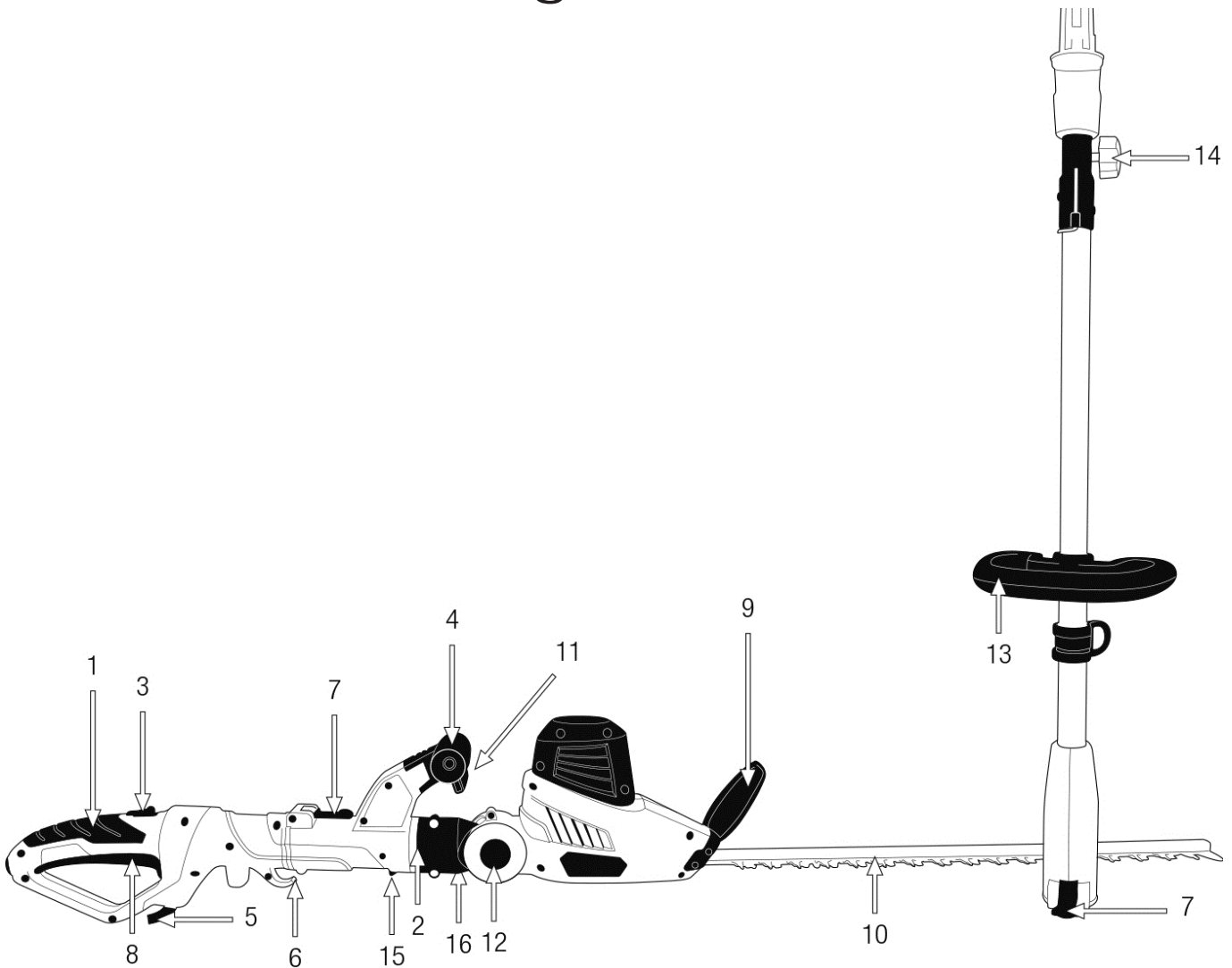

1.Rear Handle

2.Rotation Angle Of The
Head Block

3.Lock Switch

4.Front Handle

5.Power Cord

6.Cable Hook

7.Lock Buckle

8.Trigger switch

9.Guard

10.Blade

11.Security Button

12.Unlock Button Head
Turn

13.Auxiliary Handle

14.Length Adjustment Knob

15.Unlock Button Head
Rotation

16.Turn Angle Of The Head

The diagrams and pictograms herewith enclosed in this manual are a guide but not necessarily an exact copy of the actual product.

INTENDED USE

1. Only cut hedges. Do not use this product for other uses for which the product has not been designed to carry out. Do not use this product to cut plastic parts, bricks or construction materials. Do not use this product to move objects. Any other use could lead to dangerous situations.
2. This product is intended for private domestic use only, not for any commercial trade use. It must not be used for any purposes other than those described.

ASSEMBLY

Unpack

1. Carefully remove the product and any accessories from the box. Make sure that all items listed in the packing list are included.
2. Inspect the product carefully to make sure no breakage or damage occurred during shipping.
3. Do not discard the packing material until you have carefully inspected and satisfactorily operated the product.
4. If any parts are damaged or missing, contact our customer service center.

NOTE: Be careful with small parts that are removed during assembly or when making adjustments. Make sure you do not lose them.



WARNING: If any parts are damaged or missing, do not operate this product until the parts are replaced. Failure to heed this warning could result in serious personal injury.



WARNING: Do not attempt to modify this product or create accessories not recommended for use with this product. Any such alteration or modification is misuse and could result in a hazardous condition leading to possible serious personal injury.



WARNING: Do not connect to power supply until assembly is complete. Failure to comply could result in accidental starting and possible serious personal injury.

PACKING LIST

- Hedge trimmer	1 pc
- Bar Sheath	1 pc
- Guard	1 pc
- Guard Screw	4 pcs
- Hex. Key	1 pc
- User Manual	1 pc
- Extension Tube	1 pc
- Shoulder Strap	1 pc

The Guard

Place guard as shown this Figure, Insert the 4pcs screws and tighten

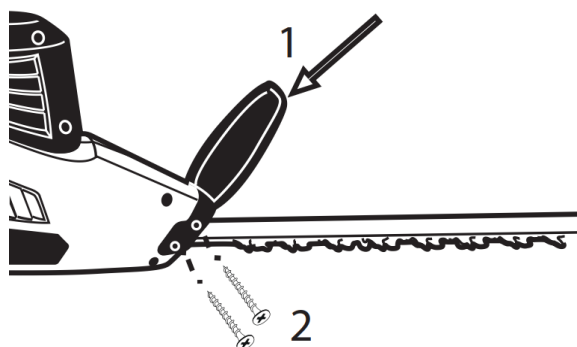

The normal hedge trimmer:

1. Open the lock buckle1 of the front handle.

2. Insert the rear handle into the opening of front handle.
3. Lock the lock buckle1 of the front handle.

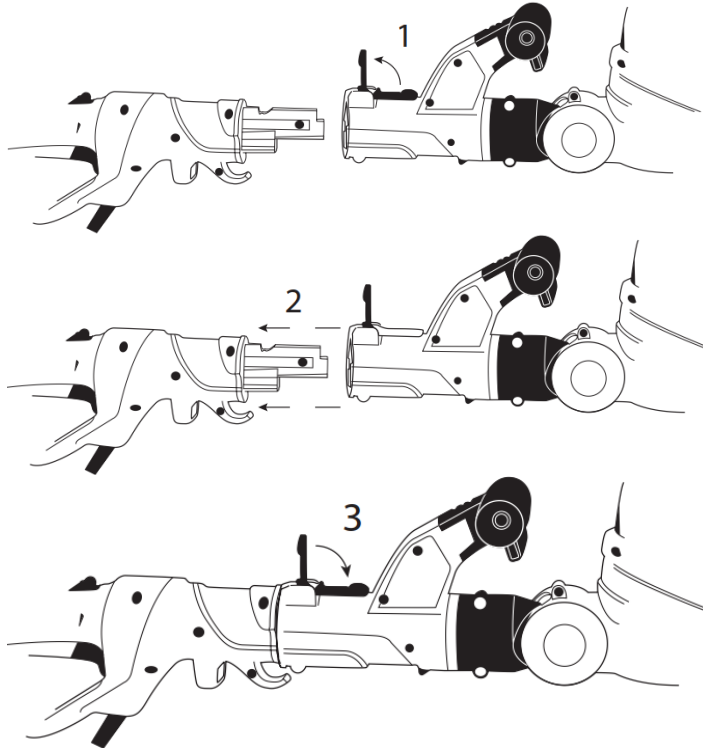

The pole hedge trimmer:

1. Unlock the lock buckle1 of the front handle.
2. Insert the front hexagonal aluminum pipe joint into the opening of the front handle.
3. Lock the lock buckle1 of the front handle.
4. Unlock the lock buckle 2 of telescopic tube.
5. Insert the rear handle into the opening of rear hexagonal aluminum pipe joint.
6. Lock the lock buckle2 of the telescopic tube.

The shoulder strap



1. Use your thumb or fingers to squeeze the safety lock piece, put the hook to the hanging part of the tool.
2. Move slide buckle to adjust the length of the shoulder strap. Adjust the length of the shoulder strap to obtain a comfortable working position. A few practices swings without starting motor should be made to determine correct balance.
3. Put the shoulder strap over your right shoulder. Carry the tool engine at the right side of your body.
4. If the shoulder strap is too close to your body, you can loose the hex screw with hex wrench, then push the lock ring further. When the distance is fit for your operation, tighten the hex screw.

The auxiliary handle

Place the auxiliary handle to telescopic tube, adjust to desired position and tighten the screw (A) by Allen key set (B) firmly.

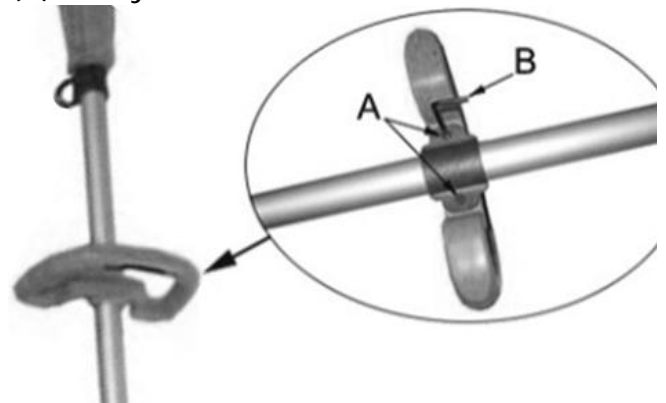

Connecting To Power Supply



WARNING: Make sure the trigger switch is released before connecting or disconnecting the power source. Refer to the "Starting and Stopping" section.

1. The cable section must be at least 1.5mm² and the cable must have a maximum length of 25m(82ft) and it must be completely unrolled before starting to work with the product .
2. This product is designed with a cord retainer that prevents the extension cord from being pulled loose while using.
3. Form a loop with the end of the extension cord.
4. Form a loop with the end of the extension cord.
5. Insert loop portion of extension cord through opening in the bottom of the rear handle and place over cord retainer.
6. Slowly pull loop against cord retainer until the slack is removed.
7. Plug product into extension cord.

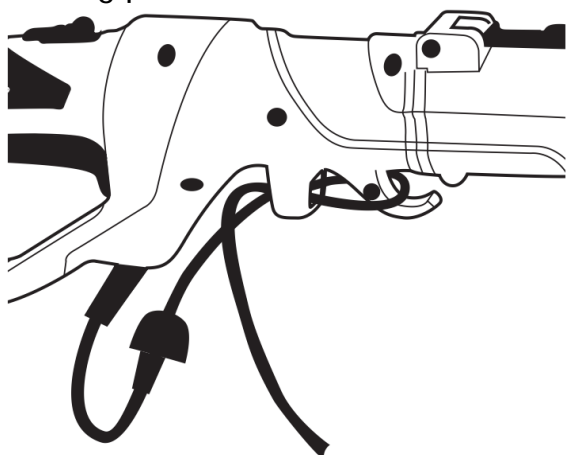

WARNING: Do not allow familiarity with this product to make you careless. Remember that a careless

fraction of a second is sufficient to inflict serious injury.

NOTE: Failure to remove all excess cord slack from extension cord retainer could result in plug loosening from receptacle.

STARTING AND STOPPING



WARNING: Always wear safety goggles or safety glasses with side shields that comply with ANSI Z87.1 when operating power tools. Failure to do so could result in objects being thrown into your eyes, resulting in possible serious injury.

After stopping the product, the blade will not stop immediately. Wait until it has stopped before carrying out any maintenance work on the product or before transporting the product. The blades don't stop immediately when releasing the on/off switch, the blades stop at least 5 seconds after.

Checking Before Starting

1. Replace parts that are cracked, chipped, or damaged in any way. Do not operate the unit with loose, damaged parts or improperly adjusted.
2. Before start up, remove the security blade sheath from the blade.
3. Make sure the guard is well fixed to the product.

The Pole Hedge Trimmer

NOTE: To help prevent the motor from

starting accidentally, the lock switch and trigger switch must both be engaged to start the unit.

Starting

1. Remove the blade sheath.
2. Place one hand on the rear handle.
Place the other hand on the front handle.
3. Press the security button.
4. Continue to press the security button.
Slide the lock switch forward, then squeeze the trigger switch to turn ON the hedge trimmer. The trimmer will stay on as long as the trigger switch is squeezed.
5. Lock switch may be released once hedge trimmer is running.



Stopping

1. Release the trigger switch.
2. Wait until cutting blade has stopped fully.

NOTE: Upon release of the trigger switch, the lock switch will reset to the locked position.

The normal hedge trimmer

Starting

1. Remove the blade sheath.
2. Place one hand on the rear handle.
Place the other hand on the auxiliary handle.
3. Slide lock switch forward.
4. Continue to hold the lock switch.
Then squeeze the trigger switch to turn ON the hedge trimmer. The

trimmer will stay on as long as the trigger switch is squeezed.

5. Lock switch may be released once pole hedge trimmer is running.

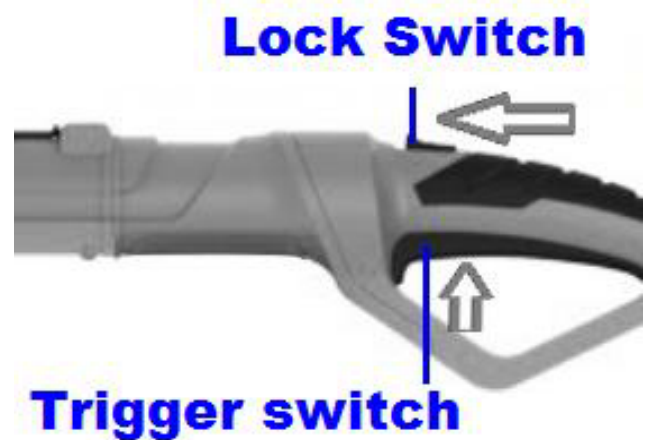

Stopping

1. Release one of the security button or the trigger switch on rear handle.
2. Wait until cutting blade has stopped fully.

OPERATION



WARNING: Do not use any attachments or accessories not recommended by the manufacturer of this product. The use of attachments or accessories not recommended can result in serious personal injury.

Repair or replace everything you need before using the product.

Holding The Unit

1. Place the holding belt as shown in the image and click onto the product using the ring.

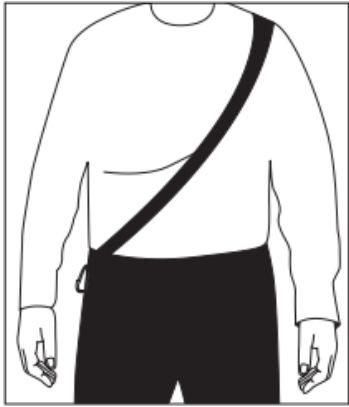

2. Always grip the unit firmly with both hands when the unit is running.

Angle Adjustment

Rotating The Head To Left And Right

1. Slide the unlock button (1) and then turn the swivel handle to the desired position. Release the lock button again and check whether the button is locked in place. See as below.

NOTE: The swivel handle can be locked in five positions (-90°, -45°, 0°, 45° and 90°). See below.

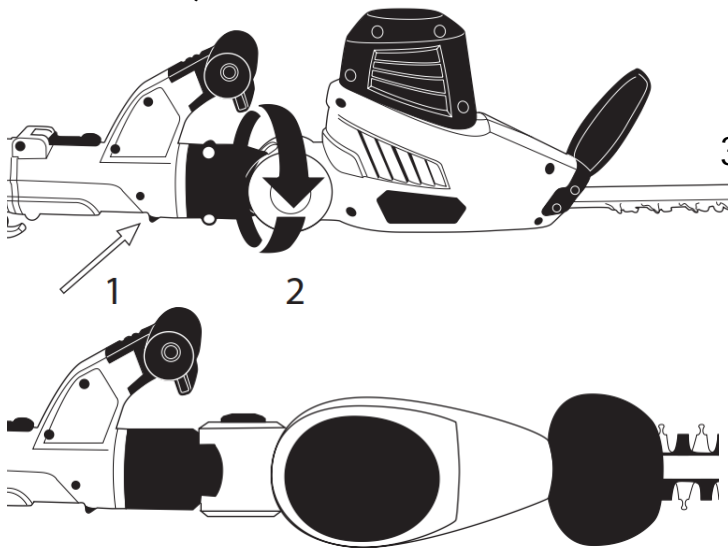

Turning The Head Up And Down

Press the up/down rotary button (1) to adjust the trimmer head angle. See as below. Adjust the attachment angle to fit the growth of the plant.

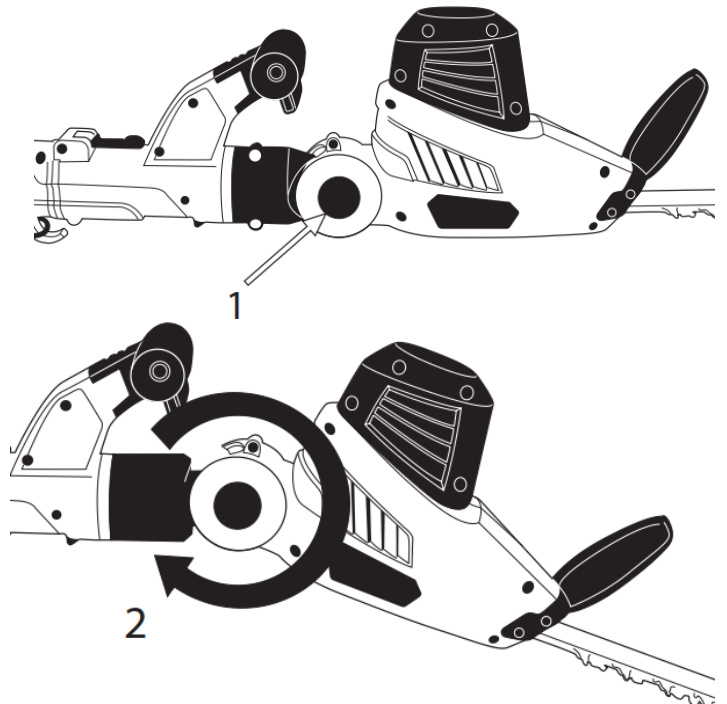

Adjusting The Pole Extension

1. Loosen the locking knob for length adjustment completely and slide the inner pole to the desired length.
2. To help maintain proper balance, only extend the pole to the minimum length required to reach the hedge being cut. Hold the unit by the pole, at the center of balance.
3. Screw the locking knob to lock the inner pole in place firmly.



While Operating

1. Always turn the unit off when operation is delayed, when setting the unit down or when moving from one working area to the next. Make sure all moving parts come to a complete stop.
2. Switch the product off immediately

if you are disturbed while working with it and when other people enter the working area. Always let the product come to complete stop before putting it down.

3. Do not overwork yourself. Take regular breaks to ensure concentrated work and full control over the product. Lack of rest and fatigue can cause accidents and damage.

Trimming Tips

1. When operating the hedge trimmer, keep the extension cord behind the user and the trimmer. Never drape it over the hedge being trimmed.
2. This tool must not be used as a lever to lift, move or split objects.
3. Keep handles dry, clean, and free from oil and grease. Greasy, oily handles are slippery causing loss of control.
4. Always disconnect the unit from the power source when it is not in use.
5. Do not force the hedge trimmer through heavy shrubbery. This can cause the blades to bind and slow down. If the blades slow down, reduce the pace.
6. Do not attempt to cut stems or twigs that are thicker than $\frac{3}{4}$ " (19 mm), or those obviously too large to feed into the cutting blade. Use a non-powered hand saw or pruning saw to trim large stems.
7. If desired, you can use a string to help cut your hedge level. Decide how high you want the hedge. Stretch a piece of string along the hedge at the desired height. Trim the hedge just above the guide line of string. Trim the side of a hedge so that it will be slightly narrower at the top. More of the hedge will be exposed when shaped this way, and it will be more uniform.
8. Wear gloves when trimming thorny or prickly growth. When trimming new growth, use a wide sweeping action, so that the stems are fed directly into the cutting blade. older growth will have thicker stems and will be trimmed easiest by using a sawing movement. The unit is used for cutting in either direction in a slow, sweeping action from side to side.
9. We recommend that you test yourself firstly with small branches in an easy position so as to get some experience before starting with more complex cuts.
10. Stand so that you are stable and balanced on both feet. Do not overreach. Be especially careful when using the product after it has rained as the ground will be slippery and you could slip.
11. Never use the hedge trimmer near power lines, fencing, posts, buildings, or other immovable objects.
12. Never use a blade after hitting a hard object without first inspecting it for damage. Do not use if any damage is detected.
13. If the cutting mechanism strikes any foreign object or the product starts making any unusual noise or vibration, shut off the power source and allow the product to stop. Take the following steps:
 - Inspect for damage.
 - Check for, and tighten, any loose

parts.

- Have any damaged parts replaced or repaired with parts having equivalent specifications.



WARNING: Always keep both hands on the hedge trimmer handles gripping surface. Never hold shrubs with one hand and operate hedge trimmer with the other. Failure to heed this warning can result in serious injury.



WARNING: Clear the area to be cut before each use. Remove all objects such as cords, lights, wire, or loose string which can become entangled in the cutting blade and create a risk of serious personal injury.



WARNING: Read the safety information for safe operation using the blade. Extreme care must be taken when using blades to ensure safe operation. Refer to General Safety Rules and Specific Safety Rules.

14. Always start the hedge cutter before placing the blade in the cutting area. Once the hedge cutter has started, place the product in the hedge in a flat position and carry out long fan like movements. If you tilt the product in the cutting direction you will obtain better cutting results.

15. Stop the engine before:

- Leaving the product unattended.
- Cleaning or when clearing a blockage,
- Checking, carrying out maintenance or working on the product,
- Adjusting the working position of the

cutting device.

16. **NOTE:** if blades do become jammed, stop the motor immediately, allow the blades to stop, and disconnect the plug from the power source before attempting to remove the obstruction.

- Make sure the product has stopped completely.
- Check that the temperature of the blade is not extremely high. Always allow the unit to cool down.
- Always use security gloves when unblocking the blade. Use appropriate tools to remove debris, e.g. a brush or wooden stick! Never use your bare hands!
- With the help of suitable tooling, remove the blocking element from the blade.

17. Prepare the product to required length attaching the pole extensions and/or the hedge trimmer shaft.

18. Cut both sides from the bottom cutting upwards to the top. This will prevent any of the cuttings falling into the path of the area still to be cut.



19. After cutting the sides proceed to the top.

20. When cutting wide hedges with the cutting area in sight move the cutting blade lightly through the cutting

surface in a sweeping motion following the shape of the hedge or shrub. A slight tilt downwards of the cutting blade in the direction of motion is recommended for optimum cutting performance.



21. Move the product with slow motion forward when cutting higher hedge and the cutting area out of sight.

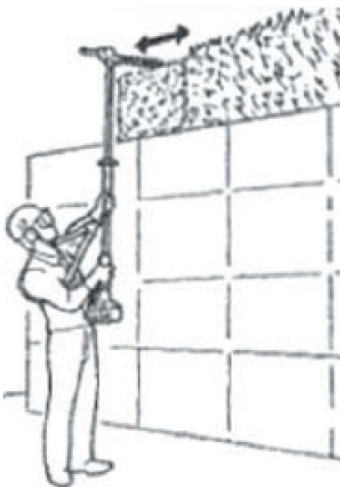

22. Do not to rush and do not attempt to cut too much with one stroke of the cutting blade.

NOTE: Try to keep the cutting blade angled at approximately 15° to the cutting surface.

23. Cut in a number of stages if the area being cut is particularly long to achieve a better result; smaller cuttings will allow for easy composting.

NOTE: When shaping it is advisable to achieve a trapezoidal shape. A trapezoidal cut corresponds to the natural growth of plants and results in optimal hedge growth, as it will expose more light to the bottom of the hedge.

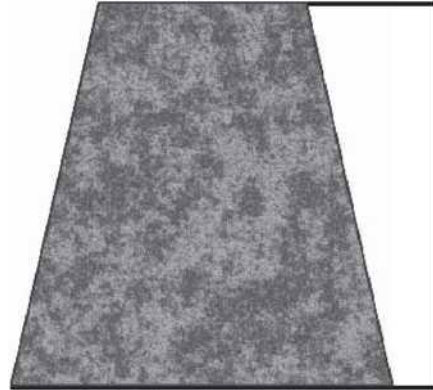

AFTER USE

1. Disconnect the product from power source. Always allow the unit to cool down before performing inspection, maintenance and cleaning work!
2. Check, clean and store the product as described below.

MAINTENANCE

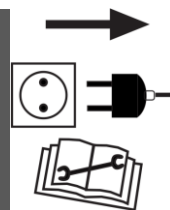

WARNING: Before inspecting, cleaning, or servicing the machine, disconnect the plug from power source and wait for all moving parts to stop. Failure to follow these instructions can result in serious personal injury or property damage. NEVER perform maintenance or repairs while the unit is running.



WARNING: When servicing, use only identical replacement parts. Use of any other parts may create a hazard or cause product damage. Do not modify the product or the

cutting elements, An inadequate use of these elements can cause SEVERE PERSONAL DAMAGES OR DEATH.



WARNING: Always wear safety goggles or safety glasses with side shields that comply with ANSI Z87.1 during product operation. If operation is dusty, also wear a dust mask. Wear ear/hearing protection when operating this unit. Use a hard hat or other type of safety helmet.



WARNING: Do not at any time let brake fluids, gasoline, petroleum-based products, penetrating oils, etc., come in contact with plastic parts. Chemicals can damage, weaken, or destroy plastic which may result in serious personal injury. All service, other than the maintenance procedures described in this manual, should be performed by an authorized service center.



WARNING: Blades are sharp, when handling the blade assembly, wear non-slip, heavy-duty protective gloves. Do not place your hand or fingers between blades or in any position where they could get pinched or cut. Never touch blades or service unit with the power supply connected.

Checking Before Each Use

1. Inspect the product before each use for worn and damaged parts.
2. Check the power cord and extension cord to detect possible damage or worn.

3. Check for loose screws, nuts or bolts are tightly secured, (tighten as needed).
4. Check the blade sharpness.

Cleaning After Each Use



WARNING: Do not use chemical, alkaline, pine and lemon, abrasive or other aggressive detergents or disinfectants to clean this product. Most plastics are susceptible to damage from various types of commercial solvents and may be damaged by their use. Use clean cloths to remove dirt, dust, oil, grease, etc.



NOTE : Always clean the product after using it. Lack of proper cleaning can cause damage to the product and produce a malfunction. Regular and proper cleaning will help ensure safe use and prolong the life of the product.

1. Stop the motor and disconnect from power supply.
2. Always use security gloves. The blade very sharp.
3. Carry out all maintenance work on a clear and flat surface. And allow the unit to cool down.
4. Clean dirt and debris from the body of the hedge trimmer, using a slightly damp cloth with a mild detergent. Use a brush to clean the blade. Never use petrol, detergents, water or any other liquid to clean the blades.
5. In particular clean the air vents after every use.
6. Remove stubborn dirt with high pressure air (max. 3 bar).

7. Wipe off any moisture with a soft cloth.
8. Lightly coat the blade and all screws with a corrosion-inhibiting oil.

Ventilation Motor Conducts

Eliminate any dirt in the ventilation conducts so as not damage the engine and avoid the machine overheating and even burning.

Checking After Each Use

1. Check for any loose, worn or damaged parts.
2. Repair or replace damaged parts and tighten loose screws, nuts or bolts as necessary or contact an authorised service centre for repair before using the product again..

Checking The Power Cord

1. Never use the product with a damaged cable or with the electric power source damaged.
2. Before connecting the product. Check the plug, power cord and extension cord periodically for damages. If you find any damages, have it repaired before operating. If the cable is damaged or broken, disconnect the product immediately. Damaged cables or twisted cables increase the risk of electric shock.
3. Damaged cords should be replaced or repaired by an authorized service center.

Blade Maintenance



When checking the blade, wait for a few moments after switching the product off, the blade will carry on moving.

1. Keep the hedging blade clean and

free of debris. Remove trimmings.

2. Keep the hedging blade sharp to retain a good cutting performance. Replace a worn or damaged cutting blade with a new one of the same type.
3. Lubricate the hedging blades regularly with oil after each use to prolong the life span of cutting blade and product. Apply light machine oil along the edge of the cutting blade.
4. The blades of this product are high quality metal and do not need to be filed. If accidentally, the blade catches on a metallic surface, touches a rock or any other hard object, a small breakage could occur. If this small breakage does not impede the blades functioning correctly, then you can carry on using the product. If, on the other hand, the product does not work properly, then take the product to customer service center.
5. Blade sharpening must be carried out by the service dealer. Do not sharpen the blade yourself. The blade must be sharpened guaranteeing the cutting angle and blade equilibrium. Blade sharpening carried out by a non expert will result in the product vibrating and will eventually cause damages to the product and usage problems to the end user.

STORAGE

1. Follow all aforementioned maintenance instructions. Clean the product as described above.
2. Store in a well-ventilated place that is inaccessible to children.

3. Attach the blade sheath.
 4. Always unplug the product from the power source before storing.
 5. Store the product and its accessories in a clean, dry, frost-free, well-ventilated place, Keep the product on a flat surface. Keep away from corrosive agents such as garden chemicals and de-icing salts.
 6. We recommend using the original package for storage or covering the product with a proper cloth or enclosure to protect it against dust.
 7. Lock up the unit to prevent unauthorized use or damage.
3. When transporting or storing the product . Attach the blade with a blade sheath. A proper use of the product will result in a reduced probability of accidental damages with the cutting elements.
 4. Protect the product from any heavy impact or strong vibrations which may occur during transportation in vehicles.
 5. Secure the product to prevent it from slipping or falling over.
 6. The product comes in a package that protects it against damages during shipping. Keep the package until you are sure that all parts have been delivered and the product is function properly. Recycle the package afterwards.

TRANSPORT

1. Disconnect the product before transporting it anywhere. Always transport the product with the engine stopped.
2. Always carry the product by the front handle when the product is not running and always at a safe distance from your body.

TROUBLESHOOTING



NOTE: Suspected malfunctions are often due to causes that the user can fix themselves. Therefore check the product using this section. In most cases the problem can be solved quickly.

WARNING: Only perform the steps described within these instructions! All further inspection, maintenance and repair work must be performed by an authorised service centre or a similarly qualified specialist if you cannot solve the problem yourself!

PROBLEM	SOLUTION
The motor will not start	
The extension cord is not securely connected to the unit or power source	Make sure each plug is securely connected
The GFCI in the outlet has tripped (if used)	Reset the GFCI
The breaker switch has tripped	Reset the breaker switch in the home electrical panel
The lock switch was not pressed	Press and hold the lock switch before squeezing the trigger switch
Cable damaged	Contact our customer service center. Do not repair cable with insulating tape
The unit is damaged	Contact our customer service center.
The blades move slowly, making noise and the blades heat up	
The blades are dry	Oil the blades
The blades are bent	Contact our customer service center
Cutting tooth damaged	Contact our customer service center
The blades too tight or loose	Tighten the nuts
The extension cord wire size is inadequate	Use an extension cord with the necessary wire size. Refer to the wire size table in the Safety section.
Engine stops	
Cutting device is blocked	Remove blockage
Excessive vibration/noise or exhaust	
Cutting device is dull/damaged	Replace with a new one
Bolts/nuts are loosen	Tighten bolts/nuts
Unsatisfactory cutting performance	
Cutting blade is dull/damaged	Have a specialist to sharpen or replace it
Cutting material exceeds capacity	Only cut materials acc. to the capacity of the product.

*If further assistance is required, contact our customer service center.