

Prior to installation, please check the items you have received against the packing list. Report any missing items to your local dealer immediately.

Protect all surfaces from sharp objects, high heat sources, direct prolonged sunlight and chemical hazards.

Professional installation is recommended.

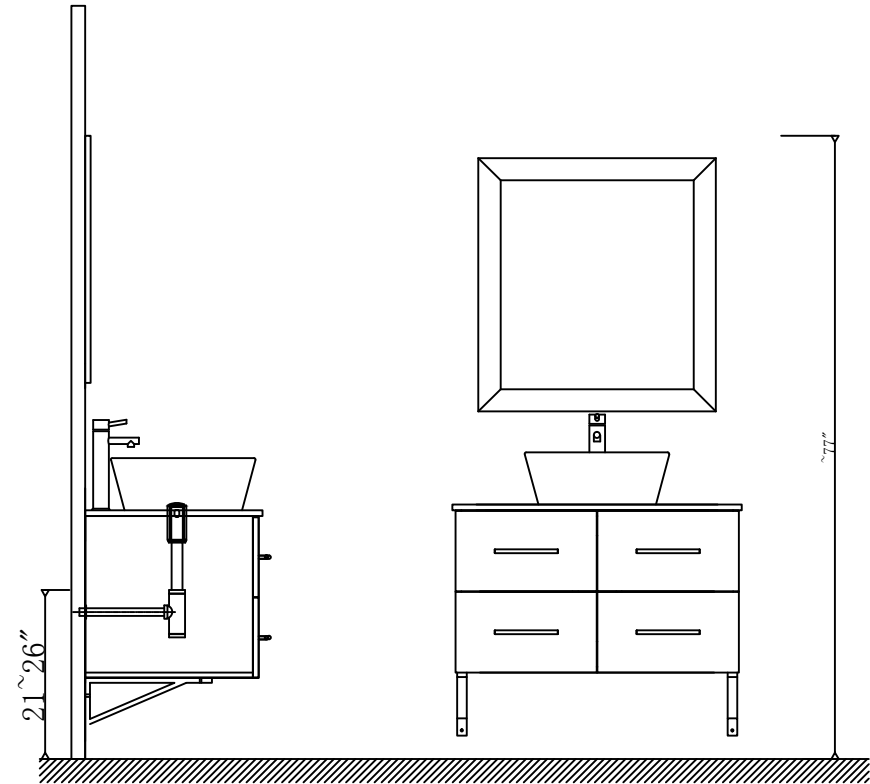

PARTS LIST (may differ depending on purchase)

Cabinet

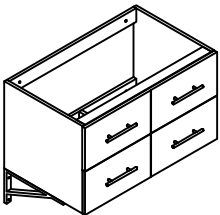

Mirror

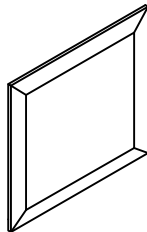

Basin

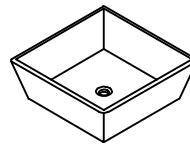

Top

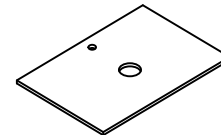

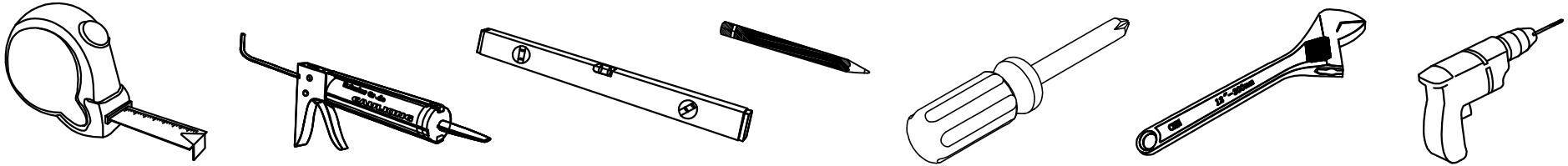
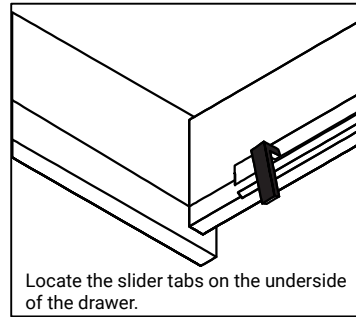
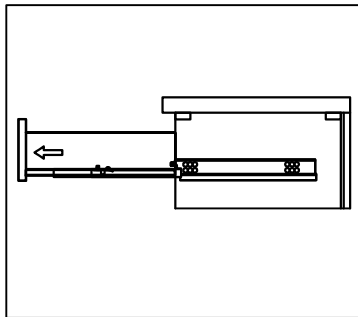
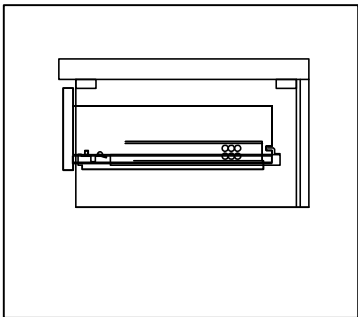
REQUIRED TOOLS**DRAWER REMOVAL****REMOVAL**

1. Pull tabs toward center
2. Lift and pull drawer out

RE-INSTALL

1. Align drawer hole with slider stud
2. Push tabs back in to secure

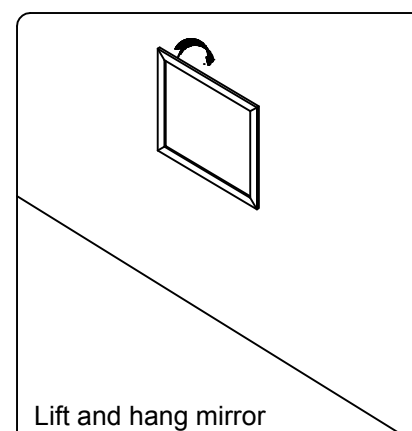
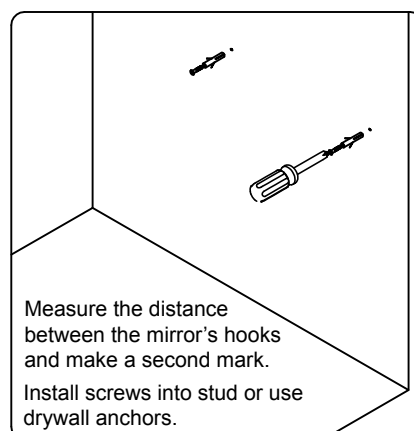
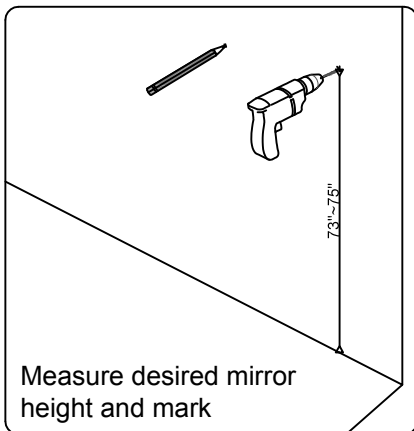
MIRROR INSTALLATION

Cabinet Installation

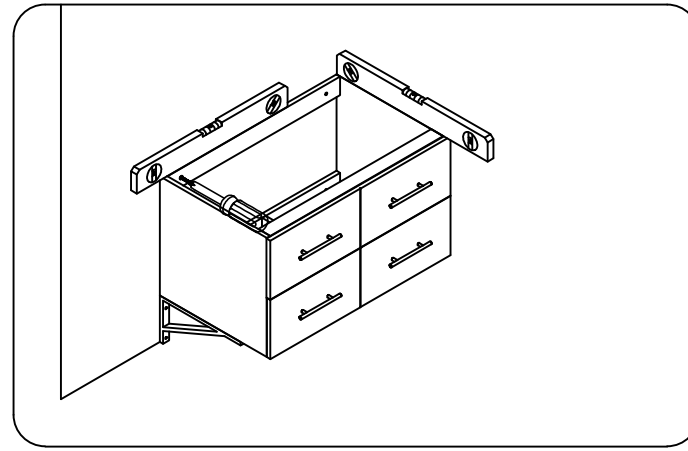
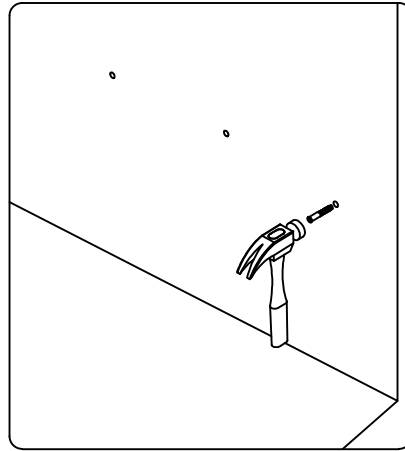
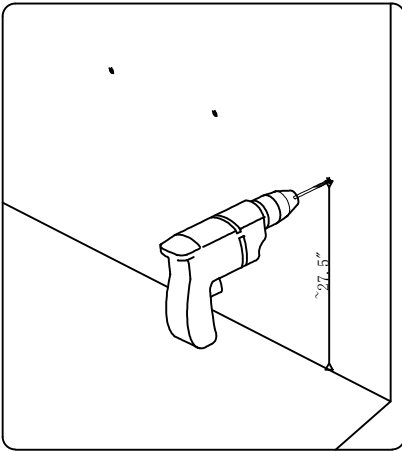

Top Installation

