



Item #XXXXXX  
Model # 4610A

## USE AND CARE GUIDE

### 4.6GAL SILENT AIR COMPRESSOR

Questions, problems, missing parts?  
Before returning to the store, call  
Husky Customer Service  
8 a.m. - 6 p.m., EST, Monday - Friday

1-888-HDHUSKY

HUSKYTOOLS.COM

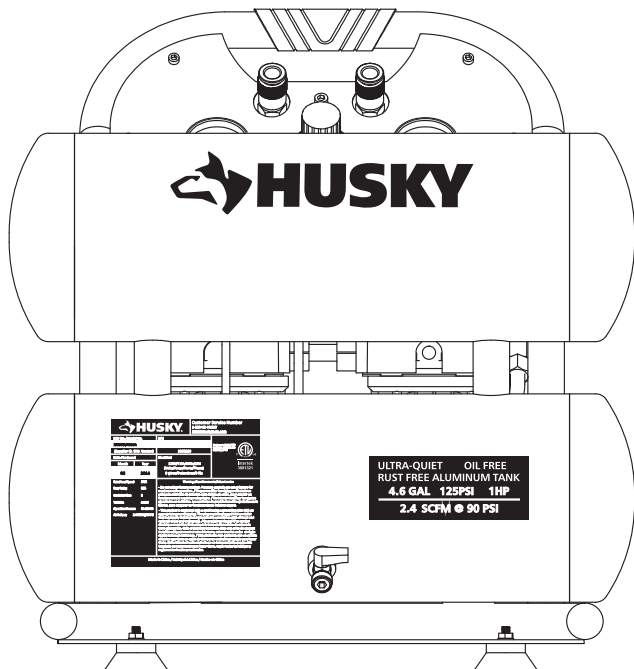

Intertek  
3081321

#### THANK YOU

*We appreciate the trust and confidence you have placed in Husky through the purchase of this air compressor. We strive to continually create quality products designed to enhance your home. Visit us online to see our full line of products available for your home improvement needs. Thank you for choosing Husky!*

## TABLE OF CONTENTS

- INTRODUCTION \_\_\_\_\_ 2
- IMPORTANT SAFETY INSTRUCTIONS \_\_\_\_\_ 3
- LOCATIONS OF IMPORTANT LABELS \_\_\_\_\_ 6
- SPECIFICATIONS \_\_\_\_\_ 7
  - Electrical Circuit \_\_\_\_\_ 7
  - Air Passage Drawing \_\_\_\_\_ 7
- AIR COMPRESSOR COMPONENTS \_\_\_\_\_ 8
- PRE-OPERATION CHECKLIST \_\_\_\_\_ 9
  - Package Contents & Assembly \_\_\_\_\_ 9
  - Inspect for Damage \_\_\_\_\_ 9
  - Save Packaging \_\_\_\_\_ 9
  - Compressor Location \_\_\_\_\_ 9
  - Electrical Power \_\_\_\_\_ 10
  - Electrical Safety \_\_\_\_\_ 10
  - Tool Usage \_\_\_\_\_ 11
- OPERATING THE AIR COMPRESSOR \_\_\_\_\_ 12
  - Preparing for start-up \_\_\_\_\_ 12
  - Starting the compressor \_\_\_\_\_ 13
  - Checking the safety valve \_\_\_\_\_ 13
  - Running the air compressor \_\_\_\_\_ 14
  - Draining the tank \_\_\_\_\_ 15
- MAINTENANCE \_\_\_\_\_ 16
  - Draining the Air Tank \_\_\_\_\_ 16
  - Changing the Air Filter \_\_\_\_\_ 16
  - Testing for Leaks \_\_\_\_\_ 16
  - Adjusting the Pressure Switch \_\_\_\_\_ 16
  - Cleaning \_\_\_\_\_ 16
- STORAGE \_\_\_\_\_ 16
- TROUBLESHOOTING \_\_\_\_\_ 17
- WARRANTY \_\_\_\_\_ 18
- PRODUCT REGISTRATION \_\_\_\_\_ 19

## INTRODUCTION

**⚠ WARNING**

This manual contains important instructions for operating this product. For your safety, and the safety of others, be sure to read this manual thoroughly before operating the product.

Failure to properly follow all the instructions and precautions can cause you and others to be seriously hurt or killed.

Thank you for purchasing a HD HUSKY Air Compressor.

Record the model and serial numbers indicated on your air compressor's nameplate:

Model No. \_\_\_\_\_

Serial No. \_\_\_\_\_

Date of Purchase: \_\_\_\_\_

Store/Dealer: \_\_\_\_\_

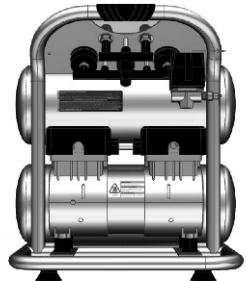

<b>HUSKY</b> Compressor Model Number	
Model No. _____	Serial No. _____
Date of Purchase _____	Store/Dealer _____
<p><b>WARRANTY</b></p> <p>This Husky Air Compressor is warranted to be free from defects in material and workmanship under normal use and service for a period of 3 years from the date of purchase. This warranty is void if the product is used for any purpose other than that intended by the manufacturer.</p> <p><b>REGISTRATION</b></p> <p>Please register your product with us to receive our newsletter and to be eligible for special offers. You can register your product online at <a href="http://www.husky.com">www.husky.com</a> or by mail to Husky Tools, Inc., P.O. Box 1000, Milwaukee, WI 53213.</p>	

**IMPORTANT SAFETY INSTRUCTIONS****Safety Messages & Signal Words:****⚠ DANGER**

Indicates an immediate hazardous situation which, if not avoided, will result in death or serious injury to the operator or to bystanders.

**⚠ WARNING**

Indicates a potentially hazardous situation which, if not avoided, could result in death or serious injury to the operator or to bystanders.

**⚠ CAUTION**

Indicates a potentially hazardous situation which, if not avoided, may result in moderate or minor injury to the operator or to bystanders.

**NOTICE**

Indicates a situation which, if not avoided, may result in damage to product components or other property.

**⚠ DANGER****KICKBACK**

Moving parts can cause severe trauma.

Keep hands and feet away from rotating parts, tie up long hair, remove jewelry, and **DO NOT** wear loose clothing.

**⚠ DANGER****SHOCK**

There is a danger of electric shock.

Use only undamaged electrical cords.

**DO NOT** touch bare wires or receptacles.

**DO NOT** operate air compressor in wet weather or in wet conditions.

**DO NOT** touch air compressor or cords if hands or feet are wet.

Ensure that all cords are free of damage before connecting to the power supply.

Ensure that you have a sufficient electrical supply for supporting the requirements of the motor.

**⚠ WARNING****RISK TO BREATHING**

Dust or dust-like particulates caused by power-sanding, sawing, grinding, drilling or any other construction-like activities can contain contaminants that are harmful to breathe.

Always use your air compressor in a well-ventilated and clean area.

Never breathe the air that comes directly out of the air compressor or air hose. This air is not suitable for breathing.

Always wear approved safety equipment. When performing dust-creating activities, securely wear properly-fit face masks or respirators.

If you feel ill from breathing while operating your air compressor, stop and seek medical attention immediately.

**⚠ WARNING****HOT SURFACE****FIRE**

Air compressor surfaces become hot during operation.

**DO NOT** touch hot surfaces, because they can cause severe burns.

Do not touch the air compressor's cylinder head. During operation, the cooling fins of the cylinder head and delivery pipe become hot.

Allow the air compressor to cool before touching it.

**DO NOT** place a storage cover on the unit during operation. Only place a cover on the air compressor after it has thoroughly cooled down.

**⚠ WARNING****FLYING OBJECTS**

Flying objects can cause injury to the eyes, head and other parts of the body.

Air-powered equipment and power tools are capable of propelling items (metal chips, fasteners and particulates) at high speed into the air and could result in injury.

Always wear approved head and eye protection.

Never point the air stream at any part of your body, or at another person or animal.

When operating the air compressor, make sure all other people and animals maintain a safe distance.

Do not move the air compressor when the air tank is under pressure.

Never use the air hoses to pull or move the air compressor.

Keep the air compressor on a flat surface.

**⚠ WARNING****EXPLOSION**

Exercise caution when using pressurized air.

To prevent injury and for your general safety, only use high-pressure hoses, fittings and couplings designed for use with air compressors.

Inspect all hoses, fittings and couplings for leaks and wear. When leaks and wear are detected, stop use and replace those items immediately. Do not repair.

Never leave pressurized air in the air tank when performing maintenance.

Never leave the air compressor unattended with the power supply in use and the air hose connected.

**⚠ WARNING****EXPLOSION**

Improper care could lead to the air tank bursting or exploding.

Drain air tank daily or after each use to prevent moisture buildup in the air tank.

Rust can weaken the air tank and cause leaks or bursting. If rust is detected, replace tank immediately. Do not try to repair the air tank by welding, drilling or modifying it in any other way. These modifications can weaken the air tank and cause a hazardous condition.

If air tank develops a leak, replace the air tank immediately. Never repair, weld or make modifications to the air tank or its attachments.

Never make adjustments to the factory-set pressures.

Never exceed manufacturer's maximum-allowable pressure rating attachments.

Because of extreme heat, do not use plastic pipe or lead tin solder joints for a discharge line.

**⚠ WARNING****EXPLOSION****FIRE**

Use caution to minimize risk of fire or explosion.

It is normal for the air compressor motor and pressure switch to produce sparks while operating. If sparks come in contact with vapors from gasoline or solvents, they may ignite and cause a fire or explosion.

Abrasive tools such as grinders, drills and other tools are capable of making sparks that can ignite flammable materials.

Always operate the air compressor a safe distance away from flammable items. Use in well-ventilated areas.

Never exceed the maximum rated pressure.

**⚠ CAUTION**

Use caution when using extension cords.

Use an extension cord which is no more than 25 feet long and at least 14 gauge.

Using an excessively long or thin-wired extension cord will cause severe damage to the motor.

Use only a 3-wire extension cord that has a 3-blade grounding plug.

## LOCATIONS OF IMPORTANT LABELS

Read these important labels before operating.

These labels provide important safety and maintenance information. These labels should be considered as permanent parts of the air compressor. Should any of these labels become illegible, damaged or removed, please contact

Model: 4610A

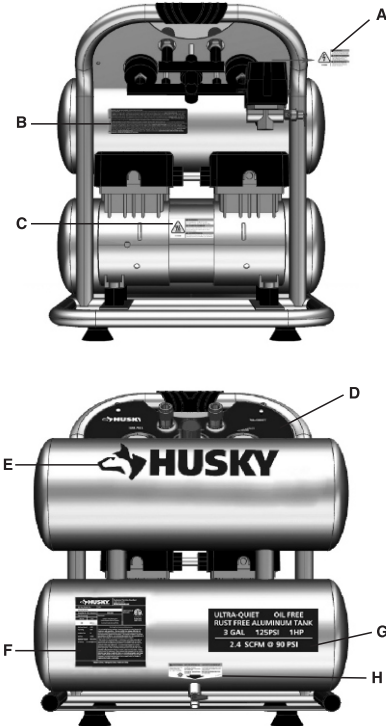

PRODUCT LABEL	
A	<p><b>WARNING</b>          HIGH VOLTAGE          DO NOT TOUCH          UNPLUGGED          ELECTRICAL          CONNECTIONS          TO AVOID          ELECTRICAL          SHOCK</p>
B	<p><b>WARNING</b>          READ AND FOLLOW MANUAL FOR ALL USES          See the Manual for important safety information. Failure to read and follow the manual could result in personal injury or property damage. The manual contains important safety information and instructions for use. Read the manual before using the product. The manual contains important safety information and instructions for use. Read the manual before using the product. The manual contains important safety information and instructions for use. Read the manual before using the product.</p>
C	<p><b>WARNING</b>          HOT SURFACES DO NOT TOUCH          ALLOW TO COOL BEFORE SERVICING  <b>ADVERTENCIA</b>          SUPERFICIES CALIENTES SOLO TOQUE SI          ESTAN FRIAS O DESPUES DE          SERVICIO  <b>AVERTISSEMENT</b>          SURFACES CHAUDES NE TOUCHEZ PAS          JUSQU'À CE QU'ELLES SE SOIENT          FROIDES</p>
D	<p><b>ULTRA-QUIET</b></p>
E	<p><b>HUSKY</b></p>
F	<p><b>HUSKY</b> Customer Service Number          1-800-4-A-HUSKY          1-800-428-4875          1-800-428-4875          1-800-428-4875</p>
G	<p><b>ULTRA-QUIET OIL FREE          RUST FREE ALUMINUM TANK          4.6 GAL 125PSI 1HP          2.4 SCFM @ 90 PSI</b></p>
H	<p><b>WARNING</b> <b>ADVERTENCIA</b> <b>AVERTISSEMENT</b>          DRAIN TANK ONLY FOR WATER          AFTER EACH USE. DO NOT USE FOR          OTHER LIQUIDS OR GASES.          LE TANK EST DESTINE          UNIQUEMENT POUR          LE DRAINAGE          DE L'EAU.          NE PAS UTILISER          POUR D'AUTRES          LIQUIDES OU GAZES.</p>

# SPECIFICATIONS

## Electrical Circuit

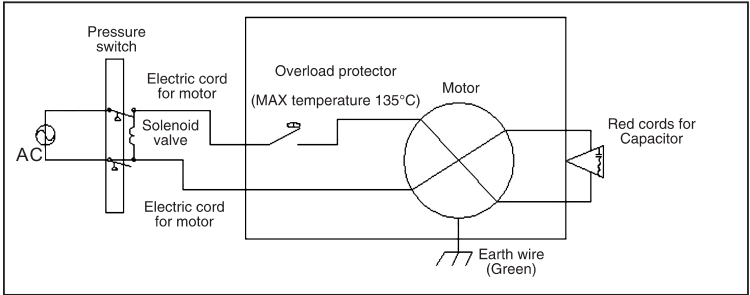

## Air Passage Drawing

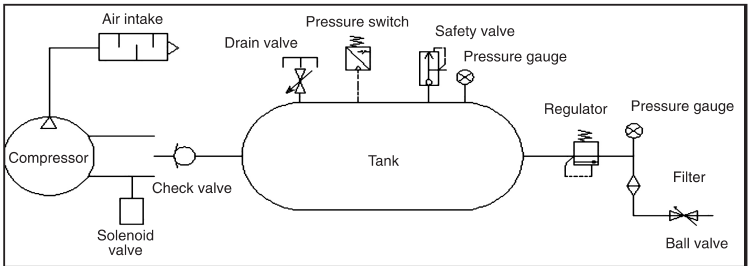

Air Compressor Model	4610A
Output @ 40 PSI	3.1 CFM
Output @ 90 PSI	2.1 CFM
Maximum Pressure	125PSI
<b>Engine</b>	
Engine Type	Electric
Horsepower	1.0 hp
Engine Speed	1680 RPM
Voltage / Hertz	120V / 60HZ
<b>Features</b>	
Pump	Oil-Free
Decibel Level	71 db
Tank Capacity	4.6 Gallons
Tank Type	Aluminum
Pressure Control Meter	2
Universal Quick Connectors	2
Thermal Overload Protection	Yes
<b>Dimensions</b>	
Length	20.87 inches (53.0 cm)
Width	17.91 inches (45.5 cm)
Height	21.26 inches (54.0 cm)
Weight	43.5lbs 19.7KG

### AIR COMPRESSOR COMPONENTS

Model: 4610A

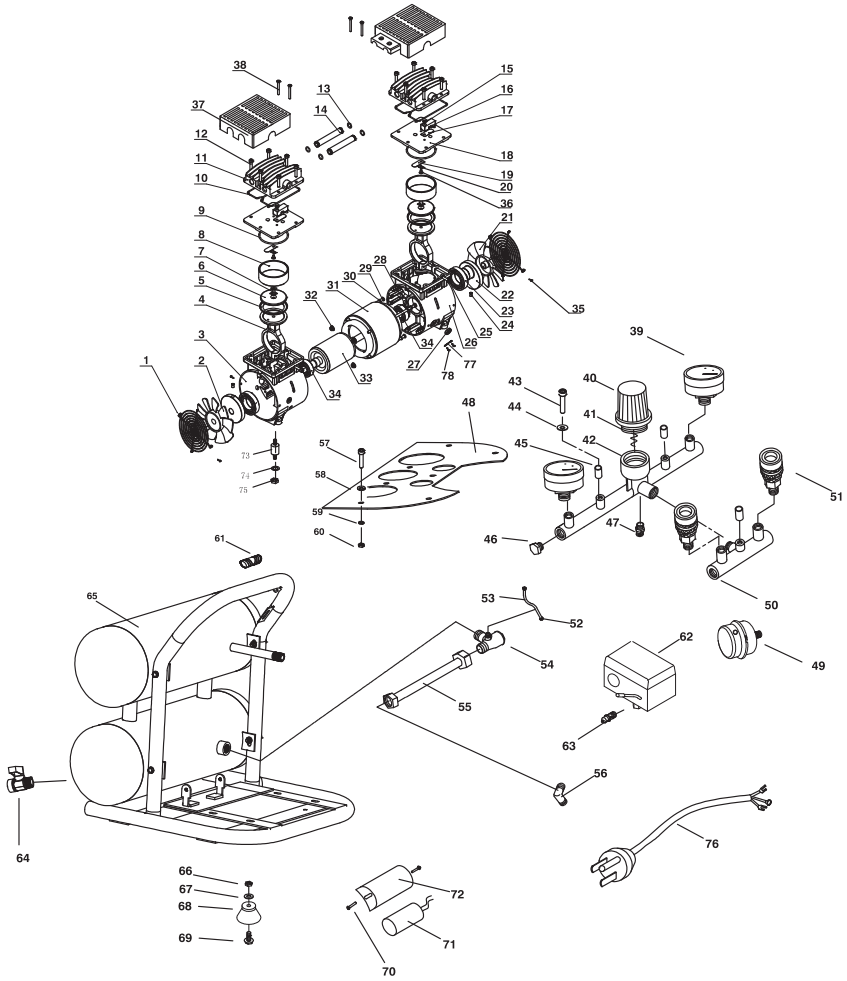

part list

1 covery	11 cylinder head	21 right fan	31 stator	41 spring	51 swpport	61 handle	71 capacitor
2 left fan	12 bolt	22 shaft seal	32 nut	42 swpport	52 Unloading Nut	62 pressureswitch	72 capacitor cover
3 leftcrankcase	13 obturatingring	23 bearing6908-ZZ	33 rotor	43 bolt	53 Unloading Pipe	63 safety valve	73 vibrationcolnmn
4 connectingrod	14 connectingpipe	24 bolt	34 bearing6203-ZZ	44 Bracket	54 checkvalve	64 drain cock	74 Bracket
5 piston cup	15 bolt	25 bolt	35 bolt	45 Bracket	55 pipe	65 tank	75 nut
6 Binder plate	16 limitedblock	26 right canckcase	36 bolt	46 choke plug	56 elbow	66 nut	76 plug
7 bolt	17 valve	27 protectionring	37 pro tect cover	47 connect	57 bolt	67 washer	77 Wire clip
8 cylinder	18 valve	28 bolt	38 bolt	48 panel	58 Abjustingwasher	68 cushion foot	78 bolt
9 obturatingring	19 valve plate	29 bolt	39 50gauge	49 air filter	59 Abjustingwasher	69 bolt	
10 obturatingring	20 washer	30 spring	40 regulator	50 swpport	60 spring	70 bolt	

## PRE-OPERATION CHECKLIST

### Package Contents & Assembly

**Model:** 4610A

**Package contents:**

- Air Compressor
- Owner's Manual
- Air Filter

**Assembly:**

- Attach the air filter and screw it in properly.



### Inspect for Damage

Before using the air compressor, make sure the air tank is not damaged, inspect all parts for damage, and check that all pipes are firmly connected.

Do not use the air compressor if any damage is found. If damaged, have an authorized service center inspect and test the air compressor to ensure that it is working properly.

### Save Packaging

Save all outside packaging in case you ever need to return the product for service or repair.

### Compressor Location

#### Use on Flat Surface

For proper operation, the air compressor must be placed on a flat surface with an incline no greater than 15 degrees.

### Maintain a Clear Area

It is very important that the air compressor is positioned so that there is adequate airflow around the machine. There must be at least 2 feet of obstacle-free space surrounding and above the air compressor.

## ⚠ WARNING



### RISK TO BREATHING

Dust or dust-like particulates caused by power-sanding, sawing, grinding, drilling or any other construction-like activities can contain contaminants that are harmful to breathe.

Always use your air compressor in a well-ventilated and clean area.

Never breathe the air that comes directly out of the air compressor or air hose. This air is not suitable for breathing.

Always wear approved safety equipment. When performing dust-creating activities, securely wear properly-fit face masks or respirators.

If you feel ill from breathing while operating your air compressor, stop and seek medical attention immediately.

### Use in Areas with Clean Air

For proper operation and to maximize the longevity of the air compressor, it is very important that the air drawn into the air compressor is clean. The air compressor should not be used in areas where dust or particulates are in the air. This will damage the motor and impair proper operation.

**IMPORTANT:** Always use the air filter, properly installed.

## ⚠ WARNING



EXPLOSION



FIRE

Use caution to minimize risk of fire or explosion.

It is normal for the air compressor motor and pressure switch to produce sparks while operating. If sparks come in contact with vapors from gasoline or solvents, they may ignite and cause a fire or explosion.

Abrasive tools such as grinders, drills and other tools are capable of making sparks that can ignite flammable materials.

Always operate the air compressor a safe distance away from flammable items. Use in well-ventilated areas.

Never exceed the maximum rated pressure.

## Electrical Power

### Electrical Power Requirements

 <p><b>DANGER</b></p> <p>SHOCK</p>
<p>There is a danger of electric shock.</p> <p>Use only undamaged electrical cords.</p> <p><b>DO NOT</b> touch bare wires or receptacles.</p> <p><b>DO NOT</b> operate air compressor in wet weather or in wet conditions.</p> <p><b>DO NOT</b> touch air compressor or cords if hands or feet are wet.</p> <p>Ensure that all cords are free of damage before connecting to the power supply.</p> <p>Ensure that you have a sufficient electrical supply for supporting the requirements of the motor.</p>

- Before using the air compressor, refer to the serial label for voltage and amperage requirements. Make sure you have a sufficient electrical supply for supporting the motor's requirements.
- Use a dedicated circuit for the best results.
- Low voltage and/or an overload circuit can cause the motor's overload protection system circuit breaker to trip.

### Electrical Extension Cords

 <p><b>CAUTION</b></p>
<p>Use caution when using extension cords.</p> <p>Use an extension cord which is no more than 25 feet long and at least 14 gauge.</p> <p>Using an excessively long or thin-wired extension cord will cause severe damage to the motor.</p> <p>Use only a 3-wire extension cord that has a 3-blade grounding plug.</p>

- Inspect all electrical extension cords to ensure that they are free of damage.
- When using an extension cord, use a heavy-duty cord that is no more than 25 feet long and at least 14 gauge.
- Use only a 3-wire extension cord that has a 3-blade grounding plug.

### ELECTRICAL SAFETY (SPEED AND WIRING)

- The no-load speed of this product is approximately 3,400 rpm. This speed is not constant and decreases under a load or with lower voltage.
- For voltage, the wiring in a shop is as important as the motor's horsepower rating. A line intended only for lights cannot properly carry a power tool motor. Wire that is heavy enough for a short distance will be too light for a greater distance. A line that can support one power tool may not be able to support two or three products.

### ELECTRICAL SAFETY (GROUNDING INSTRUCTIONS)

- This product must be grounded. In the event of an electrical short circuit, grounding reduces the risk of electric shock by providing an escape wire for the electric current. This product is equipped with a cord having a grounding wire with an appropriate grounding plug. The plug must be plugged into an outlet that is properly installed and grounded in accordance with all local codes and ordinances.



**WARNING:** Improper installation of the grounding plug may result in a risk of electric shock. When repair or replacement of the cord or plug is required, do not connect the grounding wire to either flat blade terminal. The wire with insulation having an outer surface that is green with or without yellow stripes is the grounding wire.



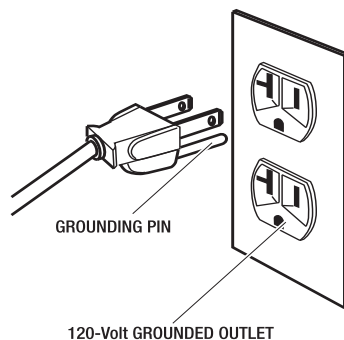







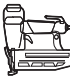

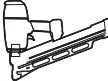
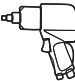
- Check with a qualified electrician or service personnel if these instructions are not completely understood or if in doubt as to whether the tool is properly grounded.
- Do not modify the plug provided; if it will not fit the outlet, have the proper outlet installed by a qualified electrician.
- This product is for use on a nominal 120-Volt circuit and has a grounding plug similar to the plug shown. Only connect the product to an outlet having the same configuration as the plug. Do not use an adapter with this product.

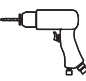

**Pre-Operation (continued)**
**TOOL USAGE**
 = Continuous

 = Intermittent

 = Not Recommended

Tool	Inflation		Finishing nailing		Framing/ Roofing	Bolting		
								
Recommended Tool Use	<input type="radio"/>	<input type="radio"/>	<input type="radio"/>	<input type="radio"/>	<input type="radio"/>	<input type="radio"/>	<input type="radio"/>	<input type="radio"/>
Tool	Cutting/Drilling			Surface Prep		Painting	HVLP Painting	Grease Gun
								
Recommended Tool Usage	<input type="radio"/>	<input type="radio"/>	<input type="radio"/>	<input type="radio"/>	<input type="radio"/>	<input type="radio"/>	<input type="radio"/>	<input type="radio"/>

## **OPERATING THE AIR COMPRESSOR**

Save this manual for future reference.

### **⚠ WARNING**

This manual contains important instructions for operating this product. For your safety, and the safety of others, be sure to read this manual thoroughly before operating the product.

Failure to properly follow all the instructions and precautions can cause you and others to be seriously hurt or killed.

### **Introduction**

- This air compressor features a compact structure, stable performance, a high airflow rate, and easy operation and maintenance. Because the air compressor produces no oil in the airflow, it can be used as an independent air supply machine for situations in which oil in the airflow is an issue.
- The motor directly drives the eccentric wheel-connecting bar system, making the piston move reciprocally. The piston is made from a high-temperature-resistant and abrasion-resistant nonmetallic material, and is able to function without lubrication for a long time.
- Compressed air discharges in the air tank. A pressure meter displays the pressure inside the tank. When the pressure inside the tank rises to 8 bar, the power is automatically cut off by the pressure-control switch. When the pressure inside the tank lowers to 6 bar, the power is turned back on by the pressure-control switch. This gradually raises the pressure in the air tank. This procedure happens repeatedly.

### **Assembly**

1. Connect your air supply hose to the the quick-connect coupling.
2. Make sure the drainage valve is off and that the pressure switch is in the OFF position.
3. Ensure that the power supply you are going to use is operating normally.
4. Insert the power supply cord into the power supply socket.

## Operation

# 1 Preparing for start-up



**WARNING:** Risk of unsafe operation. Firmly grasp air hose in hand when installing or disconnecting to prevent hose whip.



**WARNING:** Risk of unsafe operation. Do not use damaged or worn accessories.



**WARNING:** Risk of bursting. Too much air pressure causes a hazardous risk of bursting. Check the manufacturer's maximum pressure rating for air tools and accessories. The regulator outlet pressure must never exceed the maximum pressure rating.



**CAUTION:** Risk of unsafe operation. Compressed air from the unit may contain water condensation and oil mist. Do not spray unfiltered air at an item that could be damaged by moisture. Some air tools and accessories may require filtered air. Read the instructions for the air tools and accessories.



**NOTE:** A regulator **MUST** be installed when using accessories rated at less than 150 psi. The hose or accessory will require a quick connect plug if the air outlet is equipped with a quick connect socket.

- Place the AUTO/OFF switch (1) to the off position.
- Close the drain valve (2).
- Visually inspect air lines and fittings for leaks.

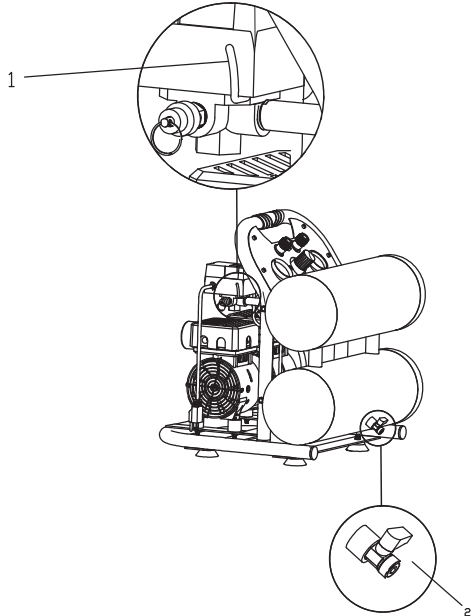

**Operation (continued)**

## 2 Starting the compressor



**WARNING:** Risk of bursting. If any unusual noise or vibration is noticed, stop the air compressor immediately and have it checked by a trained service technician.



**NOTE:** When using the regulator and other accessories, refer to the manufacturer's instructions.

- Plug the power cord into a proper receptacle.
- Turn the AUTO/OFF switch (1) to the AUTO position, and allow the tank pressure to build. The motor will stop when the tank pressure reaches "cut-out" pressure.
- Adjust the regulator (2) to a PSI setting that is needed for your application - be sure it is within the safety standards required to perform the task.

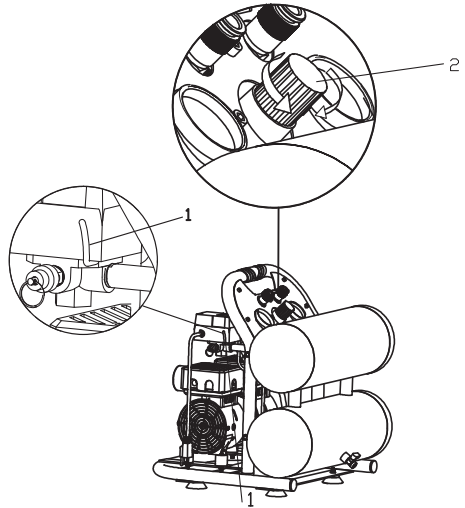

## 3 Checking the safety valve



**DANGER:** Do not tamper with the safety valve. Items loosened from this device could fly up and hit you. Failure to heed this warning could result in death or serious personal injury. The safety valve automatically releases air when the receiver pressure exceeds the preset maximum. Check the valve before each day of use by pulling the ring by hand.



**WARNING:** If air leaks after releasing the safety valve ring or if the valve is stuck, do not use the air compressor until the safety valve has been replaced. Using the air compressor in this condition could result in serious personal injury.

- Set the AUTO/OFF switch (1) to the AUTO position, and wait for the tank to fill. The compressor automatically shuts off when the pressure reaches the preset maximum.
- Set the AUTO/OFF switch (1) to the off position.
- Pull the ring on the safety valve (2) for 20 seconds to release the air.
- Release the ring. Air stops escaping at about 20 psi. If air continues to escape after releasing the safety valve ring, discontinue use and seek service before using the air compressor again.

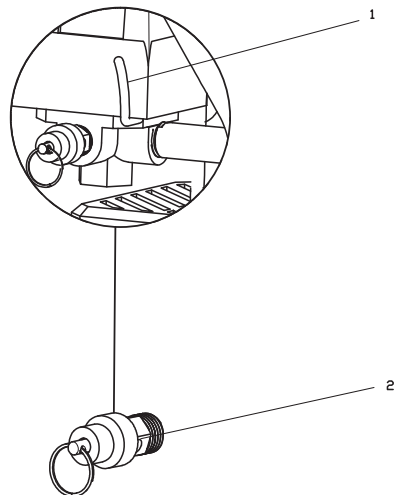

**Operation (continued)****4 Running the air compressor**

**WARNING:** Always ensure the switch is in the OFF position and regulator pressure gauge reads zero before changing air tools or disconnecting the hose from the air outlet. Failure to do so could result in possible serious personal injury.



**WARNING:** Your tool may require more air consumption than this air compressor is capable of providing. Check the tool manual to avoid damage to the tool or risk personal injury.



**NOTE:** Always use the minimum amount of air flow with the pressure regulator knob. Using a higher pressure than needed will drain air from the tank more rapidly and cause the unit to cycle on more frequently.

- Rotate the pressure regulator knob (1) to the desired line pressure. Turning the knob clockwise (+) increases air pressure at the outlet; turning counterclockwise (-) reduces air pressure at the outlet.
- If using an inflation accessory, control the amount of air flow with the pressure regulator knob (1). Turning the knob fully counterclockwise will completely stop the flow of air.
- When finished, always drain the tank and unplug the unit. Never leave the unit plugged in and/or running unattended.

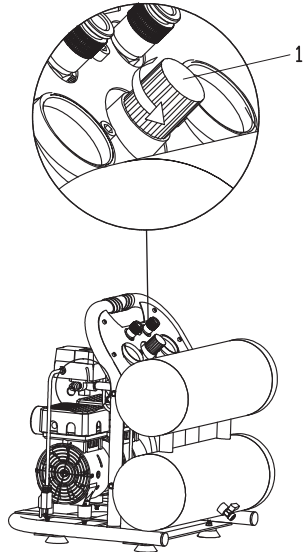

**Operation (continued)****5 Draining the tank**

**WARNING:** Risk of unsafe operation. Air tanks contain high pressure air. Keep face and other body parts away from the drain outlet. Use eye protection [ANSI Z87.1 (CAN/CSA Z94.3)] when draining, as debris can be kicked up into the face.



**WARNING:** Risk from noise. Use ear protection (ANSI S12.6 (S3.19), as air flow noise is loud when draining.



**WARNING:** Risk of bursting. Water will condense in the air tank. If not drained, water will corrode and weaken the air tank causing a risk of air tank rupture.



**NOTE:** All compressed air systems generate condensate that accumulates in any drain point (e.g., tanks, filter, after-coolers, dryers). This condensate contains lubricating oil and/or substances which may be regulated and must be disposed of in accordance with local, state, and federal laws and regulations.



**NOTE:** If the drain valve is plugged, release all air pressure. The valve can then be removed, cleaned, then reinstalled.



**NOTE:** Risk of property damage. Drained water from the air tank may contain oil and rust which can cause stains.

- Set the AUTO/OFF switch (1) to the off position.
- Slowly bleed the air from the compressor tank by pulling the safety valve to allow the pressure to escape from the tank until the pressure is approximately 20 psi.
- Drain water from the tank by opening the drain valve (2) on the bottom of the tank.
- After the water has been drained, close the drain valve. The air compressor can now be stored.

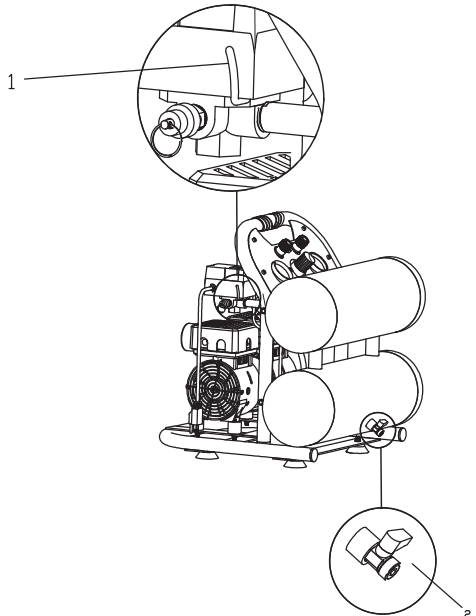

## MAINTENANCE

### Draining the Air Tank

The frequency at which you should drain the air tank depends on the environmental conditions and the amount of operating time logged. The average draining frequency is every 2 to 3 days.

1. Place the drain pipe connected to the drain valve in a container capable of holding water.
2. With compressed air in the air tank, slowly turn the drain valve knob counterclockwise. The water in the air tank will drain out.
3. After all of the accumulated water has drained out of the pipe, turn the drain valve knob clockwise until it is tight, in order to avoid leakage.

### Changing the Air Filter

An air filter is installed on the compressor's air inlet. This helps prevent the dust in the air from entering the air compressor, and reduces noise.

After being used for a period of time, the air filter will become clogged. This will reduce the air intake capabilities of the air compressor, reducing performance. Therefore, the air filter must be replaced regularly.

1. Open the lid on the air filter, then remove the old filter.
2. Replace it with a new filter, then close the lid.

### Testing for Leaks

Make sure all connections are tight. Do not overtighten.

A small leak in any hose or pipe connection will reduce the air compressor's performance.

To test for small leaks, spray a small amount of soapy water on the area suspected of leaking. If the soap bubbles, replace the broken part.

### Adjusting the Pressure Switch

The pressure switch is used to control the automatic stop-and-start function of the air compressor, ensuring the correct pressure of the compressed air in the air tank is maintained.

If the pressure of the compressed air in the air tank is found not to be in the standard range set by the manufacturer, the pressure switch must be adjusted to correctly set the activation valve. (The pressure at which the air compressor will stop running is 8 bar, and the pressure at which the air compressor will start running again is 6 bar.)

Adjust the pressure switch as follows:

1. Open the casing to access the pressure switch.
2. Adjust the setting screw for the maximum pressure. Turning the setting screw clockwise makes the activation pressure higher, so the pressure at which the air compressor stops running will be higher.
3. Adjust the setting screw for pressure difference. Turning the setting screw clockwise makes for a larger pressure difference, so the difference between the pressure at which the air compressor starts and the pressure at which the air compressor stops is larger.

Gradual adjustments should make the activation pressures within the range set by the manufacturer.

### Cleaning

Clean items with a soft brush, or wipe with a moistened cloth using a biodegradable solvent.

Do not use flammable liquids such as gasoline or alcohol. Always keep parts clean from dirt and dust for better performance.

## STORAGE

Before storing for a prolonged period of time:

1. Turn off the power supply.
2. Disconnect the power cord from the power supply.
3. Pull the relief valve and release all the pressure from the air tank.
4. Clean the air compressor to remove all dirt and dust.
5. Cover the air compressor with a cover to protect the unit from dust and moisture.
6. Do not stack or store any items on top of or around the air compressor. Damage could occur.

**TROUBLESHOOTING**

PROBLEM	POSSIBLE CAUSE	POSSIBLE SOLUTIONS
Pressure drop in the tank.	Air leaks at connections.	Let the compressor build pressure in the tank, to the maximum pressure if possible. Brush soapy water on air connections and look carefully for air bubbles. Tighten leaky connections. If the problem persists, contact the seller for further advice.
The solenoid valve leaks when the compressor is idle.	Non-return valve seal is defective.	Let the air in the tank flow out until all the pressure is released. Then remove the non-return valve plug and clean the valve seal. If necessary, replace the seal and then reinstall all components.
The compressor stopped and does not start.	Overload cutout operated because of motor overheating.	Check that the main voltage corresponds to specifications. An extension cord that is too thin or too long can cause a voltage drop and cause the motor to overheat. Allow the motor to cool down. Use heavy duty extension cords. Ensure that the compressor is plugged into a socket as close as possible to the consumer unit or fuse box.
	Motor windings are burned out.	Contact Customer Support.
The motor does not start and makes a humming noise.	Capacitor is burned out.	Replace starter capacitor.
The motor does not start or starts slowly.	Low voltage supply to the motor.	Check that the main voltage corresponds to specifications. An extension cord that is too thin or too long can cause a voltage drop and cause the motor to overheat. Allow the motor to cool down. Use heavy duty extension cords. Ensure that the compressor is plugged into a socket as close as possible to the consumer unit or fuse box.
The compressor is noisy with metallic clangs.	Compressor head gasket broken or valve faulty.	Stop the compressor and contact the dealer.
The compressor does not reach the maximum pressure.	Compressor head gasket broken or valve faulty.	Stop the compressor and contact the dealer.
The compressor doesn't seem to provide as much air as it did when new and/or the compressor cuts off within a much shorter time period.	The pressure switch needs adjusting.	Stop the compressor and contact the dealer.
	The tank is full of water due to condensation.	Open the ball valve and release the pressure. Open the drain valve and release the water within the tank.
The motor pump unit does not stop when the tank pressure reaches its maximum working pressure (8 bar or 116 PSI) and the safety valve vents air.	Pressure switch defective or needs adjusting.	Stop the compressor immediately and contact Customer Support.

## Warranty

### LIMITED WARRANTY

#### WHAT IS COVERED

The manufacturer warrants to the original retail purchaser that this product is free from defect in material and workmanship and agrees to repair or replace, at the manufacturer's discretion, any defective product free of charge within these time periods from the date of purchase.

This warranty is valid for two (2) years if the product is used for personal, family, or household use, and ninety (90) days if used for any other purpose, such as commercial or rental use.

This warranty extends to the original retail purchaser only and commences on the date of the original retail purchase.

Any part of the product manufactured or supplied by the manufacturer and found in the reasonable judgment of the manufacturer to be defective in material or workmanship will be repaired or replaced by an authorized service dealer without charge for parts and labor.

The product, including any defective part, must be returned to an authorized service dealer within the warranty period. The expense of delivering the manufacturer's product to the dealer for warranty work and the expense of returning it back to the owner after repair or replacement will be paid by the owner. The manufacturer's responsibility in respect to claims is limited to making the required repairs or replacements and no claim of breach of warranty shall be cause for cancellation or rescission of the contract of sale of any of the manufacturer's product. Proof of purchase will be required by the dealer to substantiate any warranty claim. All warranty work must be performed by an authorized service dealer.

#### WHAT IS NOT COVERED

This warranty does not cover any of the manufacturer's product that has been subject to misuse, neglect, negligence, accident, or that has been operated in any way contrary to the operating instructions as specified in this manual. This warranty does not apply to any damage to the manufacturer's product that is the result of improper maintenance or to any manufacturer's product that has been altered or modified. The warranty does not extend to repairs made necessary by normal wear or by the use of parts or accessories which are either incompatible with the manufacturer's product or adversely affect its operation, performance, or durability.

The manufacturer reserves the right to change or improve the design of any product without assuming any obligation to modify any product previously manufactured. All implied warranties are limited in duration to the stated warranty period. Accordingly, any such implied warranties including merchantability, fitness for a particular purpose, or otherwise, are disclaimed in their entirety after the expiration of the appropriate two-year or ninety day warranty period. The manufacturer's obligation under this warranty is strictly and exclusively limited to the repair or replacement of defective parts and the manufacturer does not assume or authorize anyone to assume for it any other obligation. Some states do not allow limitations on how long an implied warranty lasts, so the above limitation may not apply to you. The manufacturer assumes no responsibility for incidental, consequential, or other damages including, but not limited to, expense of returning the manufacturer's product to an authorized service dealer and expense of delivering it back to the owner, mechanic's travel time, telephone or telegram charges, rental of a like product during the time warranty service is being performed, travel, loss or damage to personal property, loss of revenue, loss of use of the product, loss of time, or inconvenience. Some states do not allow the exclusion or limitation of incidental or consequential damages, so the above limitation or exclusion may not apply to you.

This warranty gives you specific legal rights, and you may also have other rights which vary from state to state.

Contact the Customer Service Team at 1-888-HDHUSKY or visit [www.huskytools.com](http://www.huskytools.com).



Questions, problems, missing parts? Before returning to the store call  
Husky Customer Service  
8 a.m. - 6 p.m., EST, Monday-Friday

**1-888-HDHUSKY**

**HUSKYTOOLS.COM**

Retain this manual for future use.

Document Number: XXXXXXX

08/08/2014